

Installation Instructions

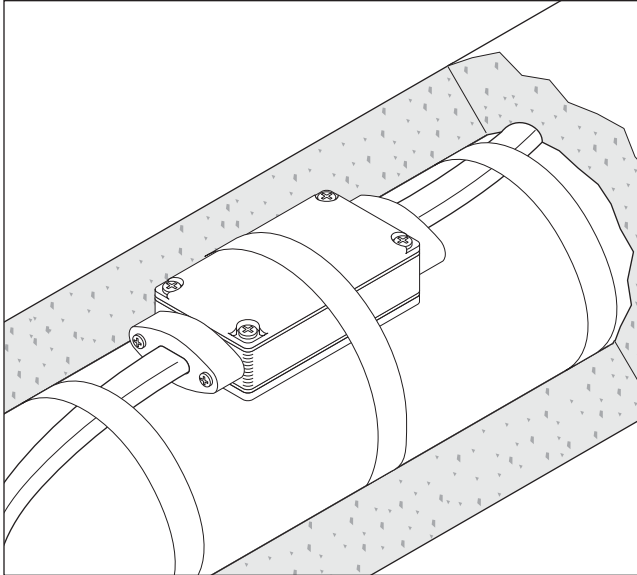

Description

The PMKG-LS is a NEMA 4X rated splice kit designed for use with Raychem® BTV-CR, BTV-CT, QTVR-CT, and LBTV2-CT self-regulating heating cables. It is designed to be placed on the pipe, under the insulation and cladding.

For technical support call Tyco Thermal Controls at (800) 545-6258.

Tools Required

- Wire cutters
- Needle nose pliers
- Screwdriver
- Utility knife

Additional Materials Required

- Two grommets:⁽¹⁾
PMK-GK-10 P/N 222724-000 (Package of ten grommets)
- Tape
 - GT-66 Installation temperature above 40°F (4°C)
 - GS-54 Installation temperature above -40°F (-40°C)

⁽¹⁾ Required for LBTV2 (see step 1).

Approvals



Hazardous Locations

Class I, Div. 2, Groups A, B, C, D
Class II, Div. 2, Groups F, G
Class III

Kit Contents

| Item | Qty | Description |
|------|-----|---------------------------------------|
| A | 1 | Body |
| B | 2 | Pressure plates with captive screws |
| C | 2 | Red grommets (not for use with LBTV2) |
| D | 2 | Gaskets |
| E | 2 | Covers with captive screws |
| F | 1 | Label |

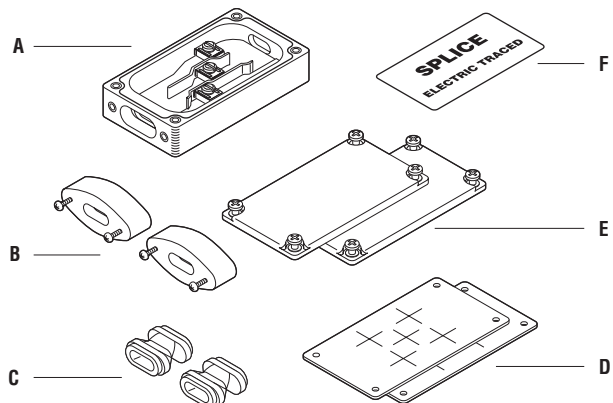

⚠ WARNING:

This component is an electrical device which must be installed correctly to ensure proper operation and to prevent shock or fire. Read these important warnings and carefully follow all of the installation instructions.

- To minimize the danger of fire from sustained electrical arcing if the heating cable is damaged or improperly installed, and to comply with the requirements of Tyco Thermal Controls, agency certifications, and National Electrical Codes, ground-fault equipment protection must be used. Arcing may not be stopped by conventional circuit breakers.

- Component approvals and performance are based on the use of Tyco Thermal Controls-specified parts only. Do not use substitute parts or vinyl electrical tape.
- The black heating cable core is conductive and can short. It must be properly insulated and kept dry.
- Damaged bus wires can overheat or short. Do not break bus wire strands when scoring the jacket or core.
- Keep components and heating cable ends dry before and during installation.

- Bus wires will short if they contact each other. Keep bus wires separated.
- Use only fire-resistant insulation materials, such as fiberglass wrap or flame-retardant foam.
- Leave these instructions with the user for future use.

PMKG-LS Installation Instructions

1

- Identify heating cable type.
- Select correct grommet from table below.

| Heating Cable | Type | Grommet |
|---------------|------------|---------|
| BTV, QTVR | -CR or -CT | RED |
| LBTV2 | -CT | K* |

* Order separately

⚠ WARNING: Use of the wrong grommet can result in leaks, cracked components, shock or dielectric failure, and will invalidate approvals and certifications

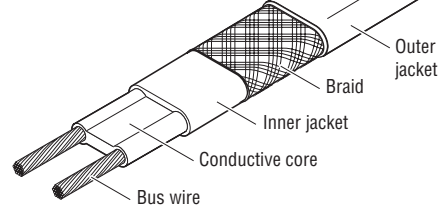

BTV-CR, BTV-CT, QTVR-CT, LBTV2-CT

2

- Allow extra heating cable as shown.

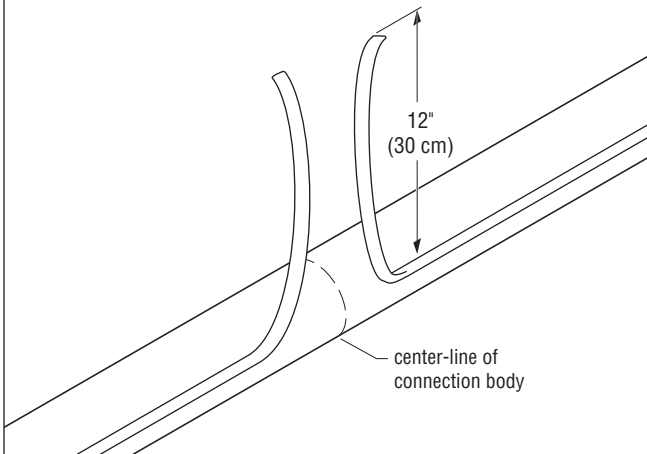

3

- Slide parts onto heating cable in order shown.

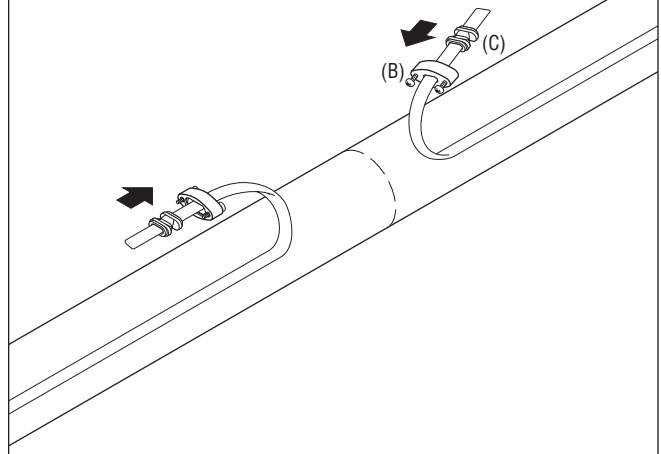

4

Do not cut braid.

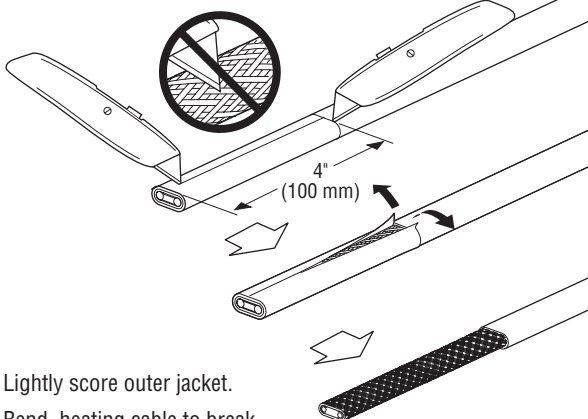

- Lightly score outer jacket.
- Bend heating cable to break jacket at score, then peel off jacket.

5

- Push braid back to create a pucker.

- At pucker use a screwdriver to open braid.

- Bend heating cable and work it through opening in braid.

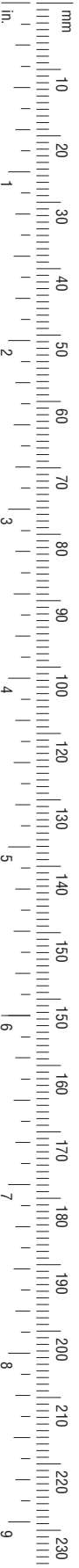
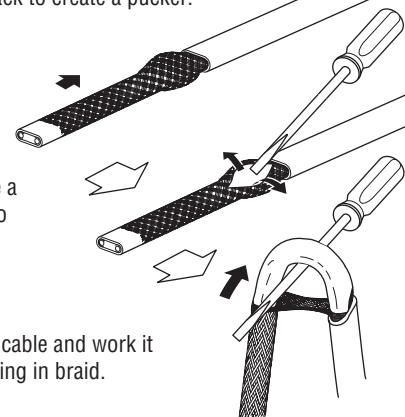

PMKG-LS Installation Instructions

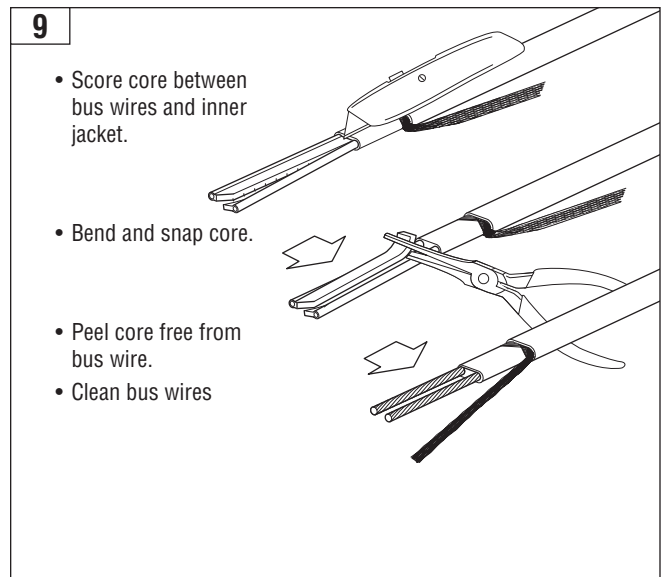
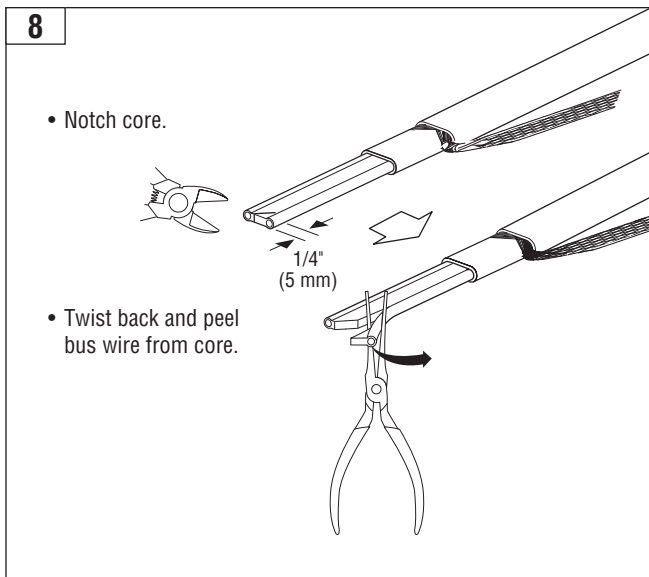
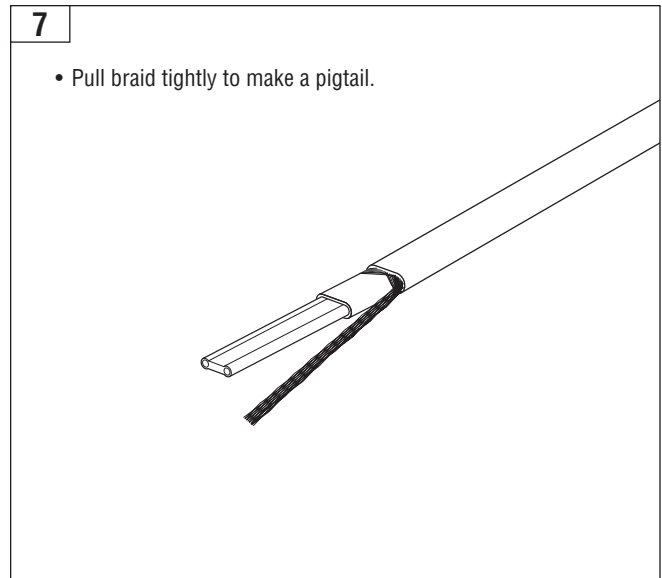
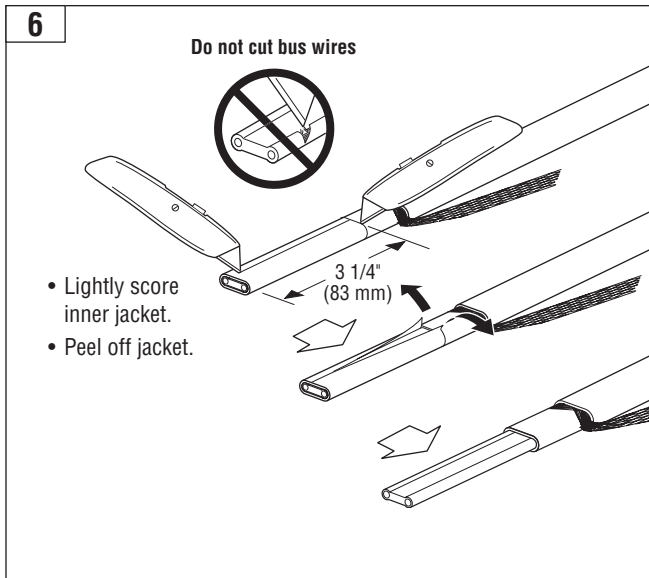
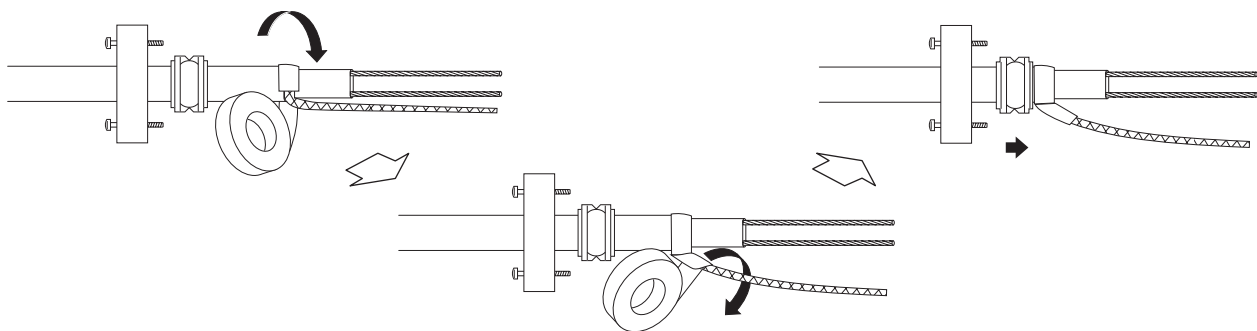
**10 For CSA Class I, II, III, Division 2 applications only**

- Using GT-66 or GS-54 glass cloth tape, hold the braid pigtail against the inner jacket, and wrap 3 times around the heating cable and braid.

- Separate the braid from the heating cable and wrap 2 wraps of tape around the braid.

- Slide the grommet to the edge of the tape. Do not push grommet onto or over the tape, leaks and dielectric failure may result.

PMKG-LS Installation Instructions

11

- Push heating cable into the body.
- Slide grommets into cavities and seat.
- Tighten pressure plate screws to body.

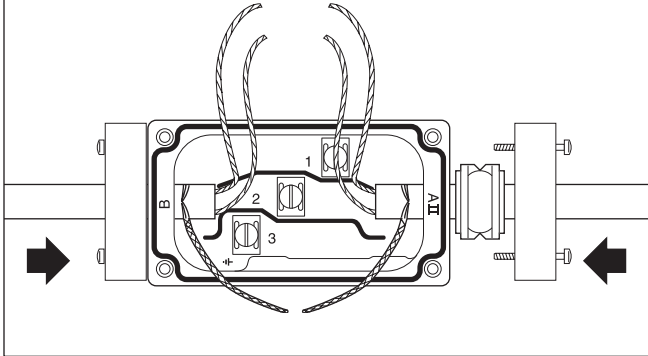

12

- Remove screws, lockwashers and clamps.
- Position wires on blocks.
- Refit clamps, lockwashers, screws, and tighten.
- Trim all extra lengths of wire and any loose braid wires.

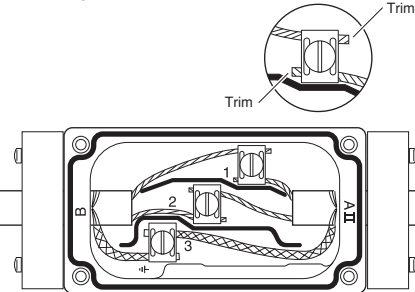

13

- Position gaskets and covers on body. Tighten screws.

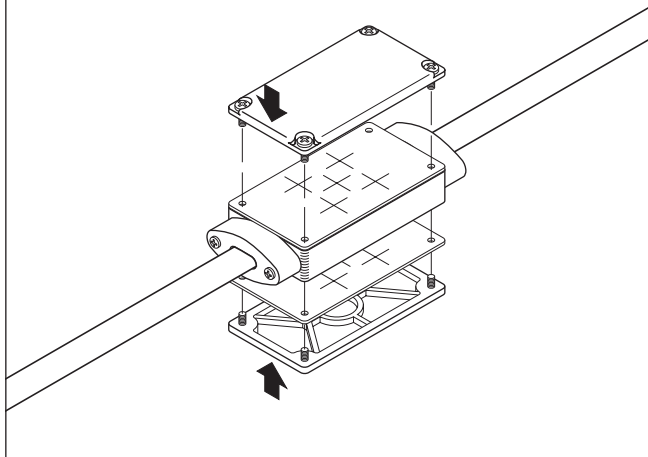

14

- Tape splice connection to pipe.
- Loop and tape extra heating cable to pipe.
- Install label on outside of cladding.

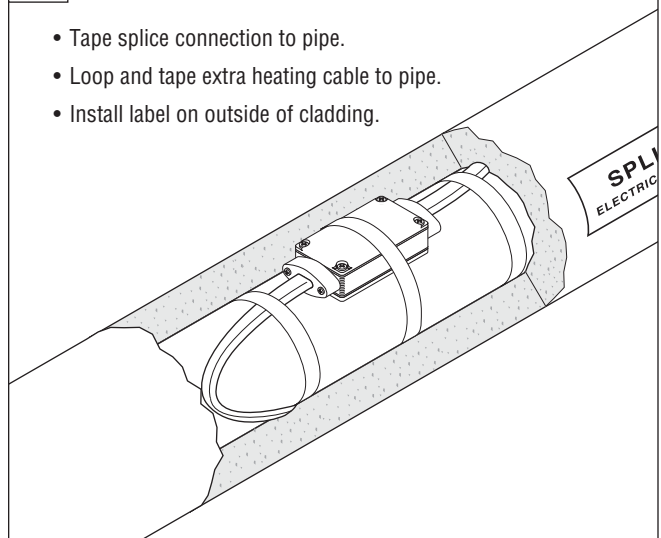

Tyco and Raychem are trademarks of Tyco Thermal Controls LLC or its affiliates.

Worldwide Headquarters
Tyco Thermal Controls
 300 Constitution Drive
 Menlo Park, CA 94025-1164
 USA
 Tel (800) 545-6258
 Fax (800) 527-5703
 Fax-on-Demand (800) 329-4494
 info@tycothermal.com
 www.tycothermal.com

Important: All information, including illustrations, is believed to be reliable. Users, however, should independently evaluate the suitability of each product for their particular application. Tyco Thermal Controls makes no warranties as to the accuracy or completeness of the information, and disclaims any liability regarding its use. Tyco Thermal Controls' only obligations are those in the Tyco Thermal Controls Standard Terms and Conditions of Sale for this product, and in no case will Tyco Thermal Controls or its distributors be liable for any incidental, indirect, or consequential damages arising from the sale, resale, use, or misuse of the product. Specifications are subject to change without notice. In addition, Tyco Thermal Controls reserves the right to make changes—without notification to Buyer—to processing or materials that do not affect compliance with any applicable specification.