

Raychem ACCESSORIES

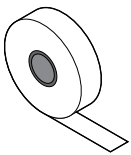

ATTACHMENT PRODUCTS

Catalog number	Part number	Description
GT-66	C77220-000	66 ft (20 m) roll of glass tape for attaching heating cable to pipe. Not for stainless steel pipes or for installation temperatures below 40°F (5°C).



GS-54	C77221-000	54 ft (16.5 m) roll of glass tape for attaching heating cable to pipe. For stainless steel pipes or for any installation below 40°F (5°C).
--------------	------------	--

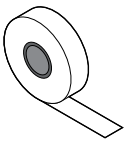

AT-180	158139-000	180 ft (55 m) roll of aluminum tape for attaching heating cables and thermostat sensors to pipes and tanks. Minimum installation temperature: 32°F (0°C). Dimensions: 2.5 in wide, 5 mils thick.
---------------	------------	--

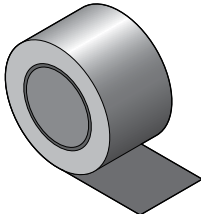

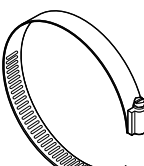
Pipe straps 	PS-01	C77211-000	For conduit ≤ 1 in
	PS-03	C77212-000	For connection kits on pipes with dimensions ≤ 2 in
	PS-10	C77213-000	For connection kits on pipes with dimensions 2 in – 10 in
	PS-20	C77216-000	For connection kits on pipes with dimensions 10 in – 19.5 in
	Used to secure connection kits and brackets to pipes. Order by pipe diameter, as shown above.		

LABELS

Catalog number	Part number	Description
ETL	C77203-000	“Electric Traced” label for identifying traced pipes and tanks.



ACCESSORIES

GLAND ENTRY KIT

Catalog number	Part number	Description	Kit Contents	
			Qty	Description
C75-100-A	000539-000	A NEMA 4X-rated gland kit used to transition heating cables into a junction box when making connections off of a pipe or tank. It may be used for power, splice, or tee connections. For use with Raychem brand BTV, QTVR, XTV, KTV ⁽¹⁾ , VPL, and LBT2-CT ⁽²⁾ heating cables. The kit does not include the junction box, flexible tubing, or tape that are required to make a complete connection.	1	Red grommet
			1	Gland with threaded inserts
			1	Gland with screws
			1	Gland gasket
			1	Locknut
			1	Green / yellow tube
			1	CS-100 core sealer
			1	Terminal block
		⁽¹⁾ For KTV only, order PMK-GP-10 grommet (P/N 700823)		
		⁽²⁾ For LBT2-CT only, order HCS-100-A heat-shrink core sealer (P/N 257649) and PMK-GK-10 grommet (P/N 222724)		

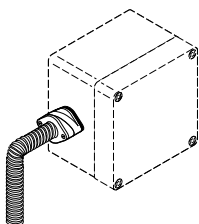

SINGLE-ENTRY TRANSITION KIT

Catalog number	Part number	Description	Kit Contents	
			Qty	Description
JS-100-A	166639-000	Junction box stand for use with Raychem brand BTV, QTVR, XTV, KTV, and VPL heating cables. A separate customer-supplied NEMA 4X junction box is required.	1	Stand assembly
			1	Lubricant
			1	Adapter for small pipes
			1	Cable tie
			1	Green / yellow tube
			1	CS-100 cold-applied core sealer
			1	JS-100 transition
			1	1-inch locknut

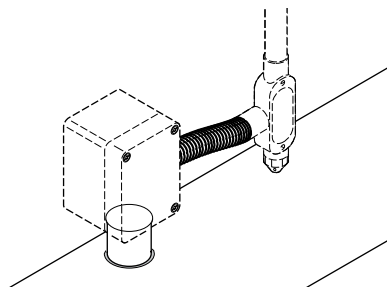

COLD-APPLIED CORE SEALER

Catalog number	Part number	Description
CS-100-A	232949-000	Replacement cold-applied core sealer for Raychem brand BTV, QTVR, XTV, KTV, and VPL heating cables

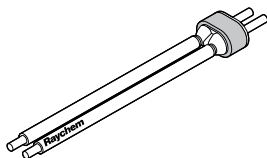

CONDUIT DRAIN

Catalog number	Part number	Description
JB-DRAIN-PLUG-3/4IN	278621-000	Pentair Thermal Management recommends the use of this 3/4-in conduit drain with each JBS-100 and JBM-100, and other enclosures with associated conduits, to prevent condensate from collecting in the box.

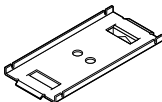
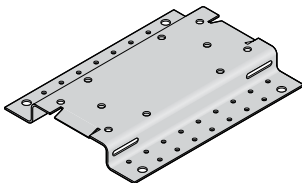
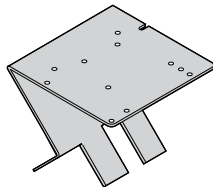
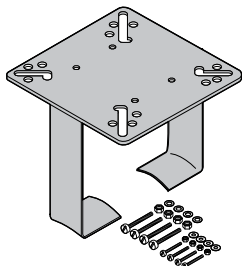

BRACKETS, ADAPTERS

Catalog number	Part number	Description
JBS-SPA 	E90515-000	Adapter for mounting E-100, JBS-100, and JS-100 to small pipe (≤ 1 inch nominal diameter).
JBM-SPA 	D55673-000	Adapter for mounting JBM-100 and T-100 to small pipe (≤ 1 inch nominal diameter).
SB-100-T 	279613-000	Adapter for mounting E-100, E-100-L, and JBS-100 connection kits on a tank surface.
UMB 	263757-000	Universal mounting bracket for mounting thermostats and other equipment on a pipe.
JB-SB-25 	471139-000	Stainless-steel mounting bracket for RAYSTAT-EX-03-A thermostat.

HELICAL FLEXIBLE PLASTIC TUBING

Catalog number	Part number	Description
HCTE-1000 	3679754004	Helical flexible plastic tubing for C75-100-A and HAK-C-100 connection kits.