

# BRONZE PENN-LUG • TYPE PNL

## 1-Hole tongue

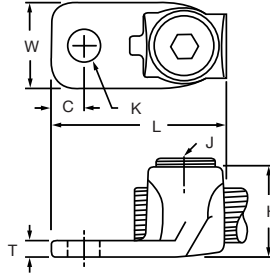

### THE ECONOMY LUG WITH QUALITY IMPROVEMENTS

Screw tightens directly on the conductor forcing the conductor into intimate contact with the body for maximum conductivity.

Flat bottom allows mounting either on tongue only or with full contact surface.

Inspection hole for proper cable insertion.

Locking boss available at an additional cost, contact factory.

Lug can be furnished electro-tinned or silver plated, as desired: For tin add "-TN" to catalogue number. For silver add "-SV" to catalogue number.



Part #	Conductor Range	Wire Diameter Range in	Fig. No.	Approximate Dimensions												Wrench Size	
				C		K		H		L		T		W			J
				in	mm	in	mm	in	mm	in	mm	in	mm	in	mm		in
PNL8	14 Solid-8 Str.	.064- .146	1	3/16	5	19/64	5	7/16	11	7/8	22	3/32	2.38	3/8	10	#12-24	Screw Driver Slot
PNL4	14 Solid-4 Str.	.064- .232	1	17/64	7	17/64	7	9/16	14	1 1/4	32	9/64	3.57	17/32	13	5/16-24	Screw Driver Slot
PNL1/0	8 Solid-1/0 Str.	.128- .375	2	3/8	10	29/64	8	29/32	20	1 19/32	40	9/64	3.57	47/64	16	1/2-20	1/4
PNL250	6 Solid-250 MCM	.162- .575	2	7/16	11	29/64	10	1 3/64	27	1 31/32	50	1/8	3.17	19/16	24	5/8-18	3/16
PNL500	4 Solid-500 MCM	.204- .815	2	3/4	19	17/32	13	1 15/32	43	3	76	1/4	6.35	1 3/8	35	15/16-16	3/8
PNL1000	500 MCM-1000MCM	.815-1.153	3	1 1/16	17	9/16	14	2	51	3 7/8	99	3/8	9.52	1 3/4	44	1 3/8-14	1/2

F

# BRONZE PENN-LUG • TYPE PNL

## 2 or 4 Hole Tongue

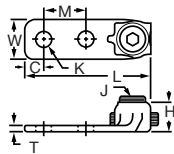

FIG. 1

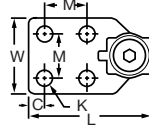

FIG. 2

Body is cast from high strength corrosion resistant copper alloy. Steel screw, cadmium plated. Lug can be furnished electro-tinned or silver plated as desired. For tin add "-TN" to catalogue number. For silver add "-SV" to catalogue number.

Part #	Conductor Range	Wire Diameter Range in	Approximate Dimensions													Fig. No.	Wrench Size		
			C		K		H		L		T		W		J			M	
			in	mm	in	mm	in	mm	in	mm	in	mm	in	mm	in			mm	
PNL1/02	8 Sol.-1/0 Str.	.128- .375	7/16	11.1	11 1/32	8.7	27/32	21	2 3/4	70	3/16	4.7	3/4	19	1/2-20	1	25	1	1/4
PNL1/02N	8 Sol.-1/0 Str.	.128- .375	5/8	15.8	9/16	14.2	27/32	21	3 3/16	90	3/16	4.7	1	25	1/2-20	1 3/4	44	1	1/4
PNL2502	6 Sol.-250 MCM	.162- .575	7/16	11.1	7/16	11.1	1 1/32	26	2 7/8	73	7/32	5.5	15/16	24	5/8-18	1	25	1	1/4
PNL2502N•	6 Sol.-250 MCM	.162- .575	5/8	15.8	9/16	14.2	1 1/8	29	4 1/4	108	7/32	5.5	1	25	3/4-16	1 3/4	44	1	3/8
PNL5002	4 Sol.-500 MCM	.204- .815	7/16	11.1	7/16	11.1	1 15/32	36	3 3/8	86	5/16	7.9	1 3/8	35	15/16-16	1	25	1	3/8
PNL5002N•	4 Sol.-500 MCM	.204- .815	5/8	15.8	9/16	14.2	1 15/32	37	4 3/8	111	5/16	7.9	1 3/8	35	15/16-16	1 3/4	44	1	3/8
PNL5004N	4 Sol.-500 MCM	.204- .815	5/8	15.8	9/16	14.2	1 15/32	37	4 3/8	111	1/4	6.3	3	76	15/16-16	1 3/4	44	2	3/8
PNL10002	500 MCM-1000 MCM	.815-1.153	9/16	14.2	9/16	14.2	2	51	4 7/8	124	3/8	9.5	1 3/4	44	1 3/8-14	1 1/2	38	1	3/8
PNL10002N•	500 MCM-1000 MCM	.815-1.153	5/8	15.8	9/16	14.2	2	51	4 7/8	124	3/8	9.5	1 15/16	49	1 3/8-14	1 3/4	44	1	3/8
PNL10004N	500 MCM-1000 MCM	.815-1.153	5/8	15.8	9/16	14.2	2	51	4 7/8	124	1/4	6.3	3	76	1 3/8-14	1 3/4	44	2	3/8

• CSA Listed