

COMBO STEEL

NBC2010 Compliant
LED 120/347VAC Input

Approvals:

CSA Certified to C22.2 #141 and C860

DESCRIPTION

The CSRP series of commercial combination steel signs and battery units features a slim profile that eliminates light leaks combined with a simple, easy to install design. Two PAR18 small style, front mounted heads are standard, PAR36 large style or MR16 type are optional.

CIRCUITRY

- LED ultra bright light source
- 120/347VAC Input, field selectable
- 1.9W power consumption for LED exit portion of combination sign
- LED Emergency DC wattages as follows: **6VDC** = 0.9W **12VDC** = 0.9W
- 6VDC or 12VDC emergency power output versions (as specified)
- Wattage capacities from 36 to 72W
- 30 minutes emergency power duration standard
- Momentary push button test switch
- Pilot LEDs for AC ON and CHARGE
- Fully automatic, current limited charger
- Solid state design and construction
- Brownout and short circuit protection
- Temperature compensated
- Maintenance free, sealed lead acid battery

MECHANICAL

- 20 Gauge steel construction
- Slide out faceplates and backplates for rapid and simple installation
- Universal spider knockout pattern stamped into backplate for junction box mounting
- Universal models include ceiling or end mount, field installable canopy kit c/w spider plate
- Multiple conduit entry knockouts
- White powder coat finish standard, other finishes and colors optional
- PAR18 small style, high impact thermoplastic heads are standard (2SM)
- Optional heads include PAR36 large style thermoplastic and die cast metal MR16 type
- Front head mounting is standard, side mount is optional

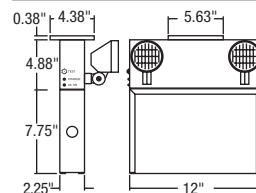
DIMENSIONS

Comes standard with three pictogram legends for direction selection.

ORDERING GUIDE

Series	Nbr of faces	Mounting	Head/Lamp	Color	Options [†]	
CSRP0636 CSRP0650 CSRP1236 CSRP1250 CSRP1272 (See model ratings table below)	U - Universal faces 1 - Single face 2 - Double face	M - Universal	0 - No heads 1SM - One PAR18 2SM - Two PAR18 1LG - One PAR36 2LG - Two PAR36	1MD - One MR16 2MD - Two MR16 1MB - One MR16 2MB - Two MR16 (See lamp list below)	WHT - White (standard) BLK - Black GRY - Grey CUS - Custom color (specify)	VDR, WRG[†], LXG, SPW, BKO, BNO, ATD, TDL^{**} 0 - No indicators (double face only) ↓ ↑ ↘ ↙ D U UR DR DL UL Note: Indicators option available for single & double option only.

[†]For detailed options descriptions, please consult the options page. * Specify AC voltage. ** Specify mounting.

LAMP SELECTION

	6 Volts	12 Volts
PAR18 - Small head		
LED	3LJ, 4LJ	3LJ, 4LJ
Quartz halogen	08Q, 10Q, 12Q	08Q, 10Q, 12Q
Tungsten	09T	09T, 12T, 18T
MR16 - Small head c/w MR16 Lamp		
LED	4LR	4LR, 6LA, 7LA
Quartz halogen	08Q, 10Q, 12Q, 20Q	08Q, 10Q, 12Q, 20Q, 35Q
PAR36 - Large head		
Quartz halogen	08Q, 10Q, 12Q, 20Q	08Q, 10Q, 12Q, 20Q
Tungsten	09T, 18T, 25T	09T, 18T
Quartz sealed beam	08SBQ, 10SBQ, 12SBQ, 20SBQ	08SBQ, 12SBQ, 20SBQ
Tungsten sealed beam	09SBT, 18SBT	25SBT

MODEL RATINGS

Model	Voltage	Wattage capacities			
		30 min.	60 min.	90 min.	120 min.
CSRP0636	6V	36	18	12	9
CSRP0650	6V	50	25	16	12
CSRP1236	12V	36	18	12	9
CSRP1250	12V	50	25	16	12
CSRP1272	12V	72	36	24	18

