

5507 SERIES™ FACEPLATES

Ordering Information

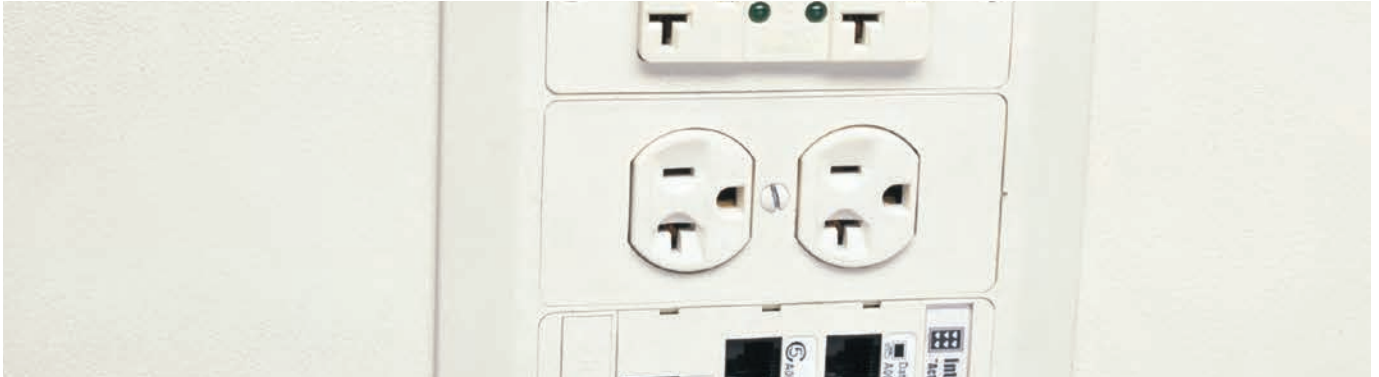

5507 Series™ Faceplates accept a wide assortment of power, A/V and datacom devices from leading manufacturers. Faceplates can be used in nonmetallic device brackets for 2300BACD, 400BAC, 5000, 5400TB, 5500BD3, 40N2 Series Raceways, 4050 Device Bracket for Steel Raceways, and WallSource™ Boxes.

NOTE: All 5507 Series™ Faceplates have a standard measurement of 4 1/4" x 1 7/8" [108mm x 34mm].

CODE REFERENCE

Listed Raceway:

File E90378 Guide RJTX.

Complies with flammability requirements of UL-5A.

Fittings: File E90377 Guide RJYT.

Meets Article 388 of NEC.

UL Listed for up to 600V.

Meets Section 12-1600 of CEC.

5507 Series Faceplates Ordering Information

Modular Furniture Adapter

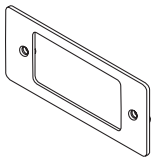
**PART NUMBERS:**

5507AD (Ivory)
5507AD-WH (White)
5507AD-GY (Gray)
5507AD-FW (Fog White)

For mounting Activate and other modular furniture bezels and other modular furniture adapters. Not for use with rectangular (decorator) style devices.

Duplex Receptacle Faceplate

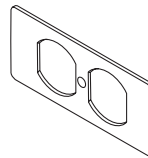
**PART NUMBERS:**

5507D (Ivory)
5507D-WH (White)
5507D-G (Gray)
5507D-GY (Light Gray)
5507D-BK (Black)
5507D-FW (Fog White)

For covering duplex style devices. Accepts 106 Frame.

Blank Faceplate

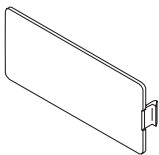
**PART NUMBERS:**

5507B (Ivory)
5507B-WH (White)
5507B-G (Gray)
5507B-GY (Light Gray)
5507B-FW (Fog White)

For covering unused compartments in the device bracket.

Flush Dual RJ Connector Faceplate

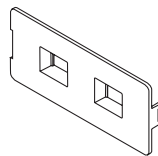
**PART NUMBERS:**

5507FRJ (Ivory)
5507FRJ-WH (White)
5507FRJ-G (Gray)
5507FRJ-GY (Light Gray)
5507FRJ-BK (Black)
5507FRJ-FW (Fog White)

For mounting one or two keystone device modules, recessed to provide a flush installation. Has one opening and one KO.

COLOR OPTIONS



5507 Series™ faceplate Part Numbers without a suffix are available in an ivory finish. Part Numbers with a "-WH" suffix have a white finish. Part Numbers with a "-G" suffix have a gray finish. Part Numbers with a "-BK" suffix have a black finish. Part Numbers with a "-FW" suffix have a fog white finish. Part numbers with a "-GY" suffix have a light gray finish.

5507 SERIES™ FACEPLATES

Ordering Information

Rectangular Receptacle Faceplate

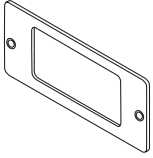

PART NUMBERS:
5507R (Ivory)
5507R-WH (White)
5507R-G (Gray)
5507R-FW (Fog White)

For covering rectangular decorator style devices.

Single Receptacle Faceplate

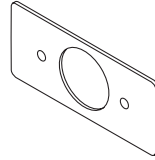

PART NUMBERS:
5507T2 (Ivory)
5507T2-WH (White)
5507T2-G (Gray)
5507T2-FW (Fog White)

For covering single receptacles 1.41" [36mm] diameter.

Dual RJ11/RJ45 Connector Faceplate

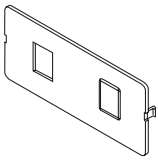

PART NUMBERS:
5507RJ (Ivory)
5507RJ-WH (White)
5507RJ-G (Gray)
5507RJ-GY (Light Gray)
5507RJ-FW (Fog White)

For mounting one or two keystone device modules. Has one opening and one KO.

Ortronics® Faceplate

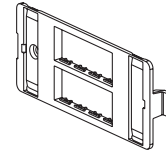

PART NUMBERS:
5507-4TJ (Ivory)
5507-4TJ-WH (White)
5507-4TJ-G (Gray)
5507-4TJ-FW (Fog White)

For mounting Ortronics® datacom inserts. Accepts four TracJack devices.

Rectangular Spacer

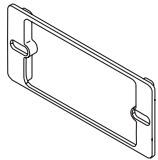

PART NUMBERS:
5507S (Ivory)
5507S-WH (White)
5507S-G (Gray)
5507S-GY (Light Gray)
5507S-BK (Black)
5507S-FW (Fog White)

For mounting commercial device plates. Installs between the device bracket and a device.

Ortronics® Faceplate

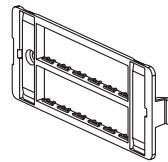

PART NUMBERS:
5507-6TJ (Ivory)
5507-6TJ-WH (White)
5507-6TJ-G (Gray)
5507-6TJ-FW (Fog White)

For mounting Ortronics® datacom inserts. Accepts six TracJack devices.

Switch Faceplate

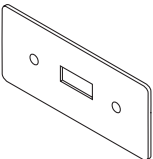

PART NUMBERS:
5507SW (Ivory)
5507SW-WH (White)
5507SW-G (Gray)
5507SW-FW (Fog White)

For covering standard toggle switches.

Extron® MAAP Faceplate

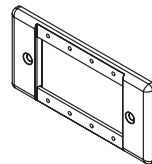

PART NUMBERS:
5507MAAP (Ivory)
5507MAAP-WH (White)
5507MAAP-G (Gray)
5507MAAP-GY (Light Gray)
5507MAAP-BK (Black)
5507MAAP-FW (Fog White)

Accepts four AVIP and Extron® Electronics MAAP single space modules.

Single Receptacle Faceplate

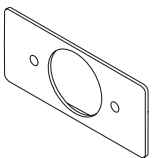

PART NUMBERS:
5507T1 (Ivory)
5507T1-WH (White)
5507T1-G (Gray)
5507T1-FW (Fog White)

For covering single receptacles 1.59" [40mm] diameter.

Extron® AAP Faceplate

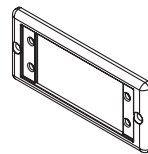

PART NUMBERS:
5507AAP (Ivory)
5507AAP-WH (White)
5507AAP-G (Gray)
5507AAP-GY (Light Gray)
5507AAP-BK (Black)
5507AAP-FW (Fog White)

Accepts two Extron® Electronics AAP single space modules.