

TSXRKY6

Non-extendable rack, Modicon premium, for single rack configuration, 6 slots

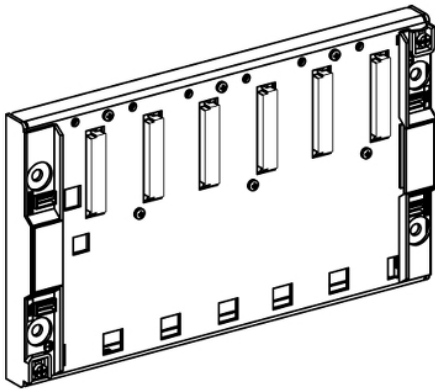

Main

Range of Product	Modicon Premium Automation platform
Product or Component Type	Non-extendable rack
Product Specific Application	For single rack configuration

Complementary

Number of slots	6
Product Compatibility	TSXPSY power supply Specific application module TSXP57 processor I/O module
Fixing mode	By 4 M6 screws panel) By clips 35 mm symmetrical DIN rail)
Marking	CE
Net Weight	3.24 lb(US) (1.47 kg)

Environment

Standards	CSA C22.2 No 213 Class I Division 2 Group D CSA C22.2 No 213 Class I Division 2 Group C 93/68/EEC 92/31/EEC 89/336/EEC UL 508 CSA C22.2 No 213 Class I Division 2 Group B CSA C22.2 No 213 Class I Division 2 Group A IEC 61131-2 73/23/EEC CSA C22.2 No 142
Product Certifications	LR[RETURN]RMRS[RETURN]BV[RETURN]ABS[RETURN]GL[RETURN]RINA[RETURN]UL[RETURN]DNV
Ambient Air Temperature for Operation	32...140 °F (0...60 °C)
Ambient Air Temperature for Storage	-13...158 °F (-25...70 °C)
Relative Humidity	10...95 % without condensation for operation 5...95 % without condensation for storage
Operating altitude	0...6561.68 ft (0...2000 m)
Protective treatment	TC
IP Degree of Protection	IP20
Pollution degree	2

Ordering and shipping details

Category	22558-TSX PREMIUM, ATRIUM & PL7 PRO
Discount Schedule	PC22
GTIN	3389110725667
Returnability	No
Country of origin	FR

Packing Units

Unit Type of Package 1	PCE
Number of Units in Package 1	1
Package 1 Height	2.05 in (5.2 cm)
Package 1 Width	8.07 in (20.5 cm)
Package 1 Length	13.78 in (35.0 cm)
Package 1 Weight	2.84 lb(US) (1.286 kg)
Unit Type of Package 2	S04
Number of Units in Package 2	9
Package 2 Height	11.81 in (30.0 cm)
Package 2 Width	15.75 in (40.0 cm)
Package 2 Length	23.62 in (60.0 cm)
Package 2 Weight	26.01 lb(US) (11.8 kg)

Offer Sustainability

California proposition 65	WARNING: This product can expose you to chemicals including: Lead and lead compounds which is known to the State of California to cause cancer and birth defects or other reproductive harm.For more information go to www.p65warnings.ca.gov
---------------------------	---

Contractual warranty

Warranty	18 months
----------	-----------

Standard and Extendable Racks for Modules Mounting

Dimensions of Modules and Racks



- (1) With screw terminal block modules.
- (2) Maximum depth for all types of modules and their associated connectors.

Racks Installation Rules

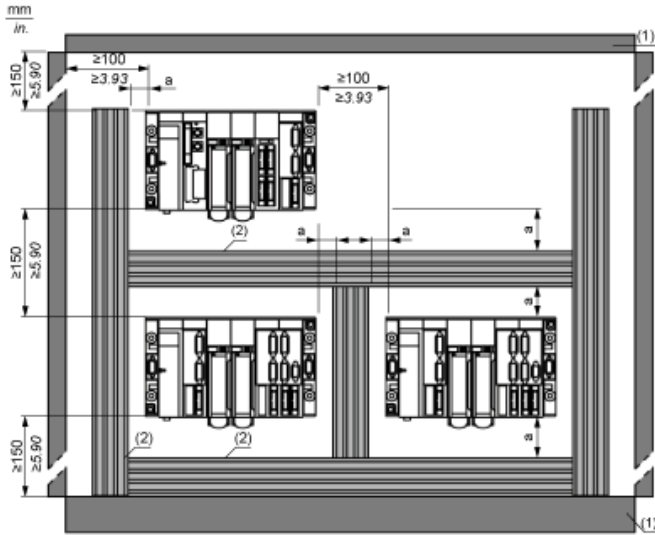

- a Greater than or equal to 50 mm / 1.97 in.
(1) Installation or casing
(2) Trough or cable tray

Rules for Installing Racks Fitted with Ventilation Modules

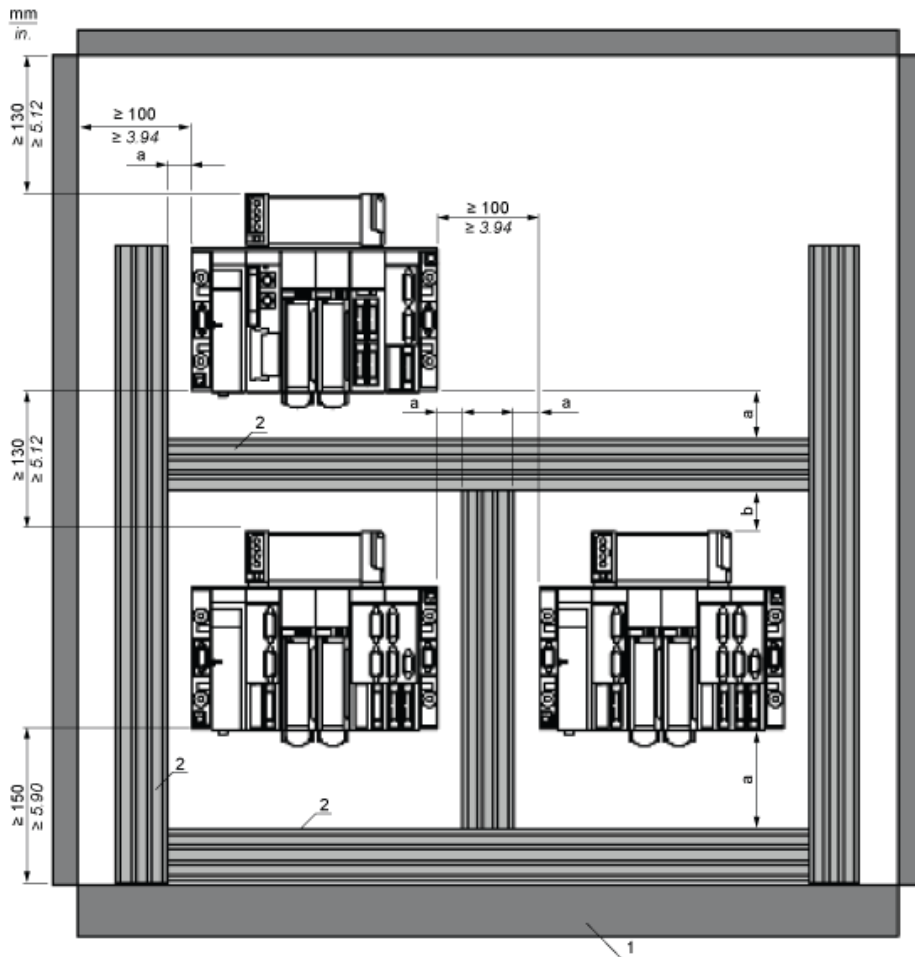

- a 50 mm / 1.97 in.
- b 30 mm / 1.18 in.
- 1 Installation or casing
- 2 Trough or cable tray

Mounting and Fixing Racks

Mounting on a 35 mm/1.38 in. Wide DIN Rail

Fixing with four M6x25 screws + washers and AF1-CF56 ¼ turn sliding nuts.

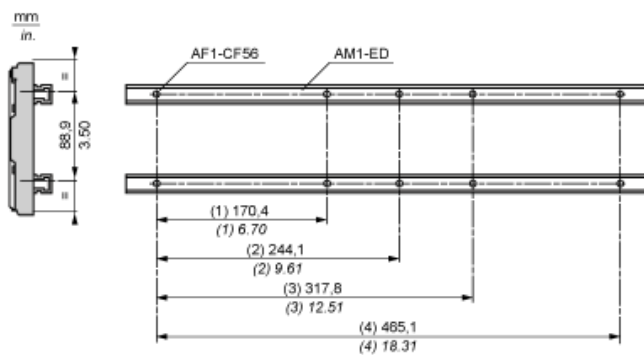

- (1) TSXRKY4EX
- (2) TSXRKY6 and TSXRK6EX
- (3) TSXRKY8 and TSXRKY8EX
- (4) TSXRKY12 and TSXRKY12EX

Mounting on a Panel

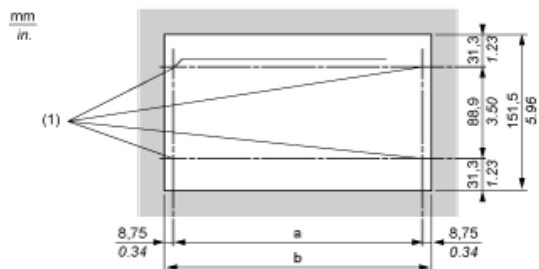

(1) 4 holes for M6 fixing screws
 a, b: see table below

Mounting on an AM1-PA Telequick Mounting Grid

Fix the rack using four M6x25 screws + washers and AF1-EA6 clips nuts.

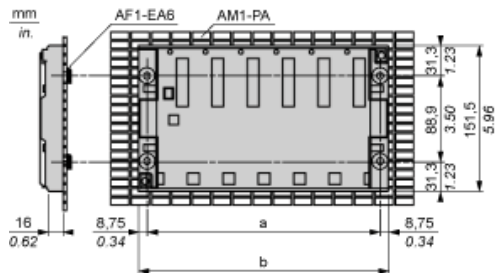

Racks	a in mm	a in in.	b in mm	b in in.
TSXRKY4EX	170.4	6.70	187.9	7.39
TSXRKY6/6EX	244.1	9.61	261.6	10.29
TSXRKY8/8EX	317.8	12.51	335.3	13.20
TSXRKY12/12EX	465.1	18.31	482.6	19

NOTE: Maximum tightening torque for fixing screws: 2.0.N.m.(1.6 Lb.-ft.)

Connection to the Ground

Grounding Racks

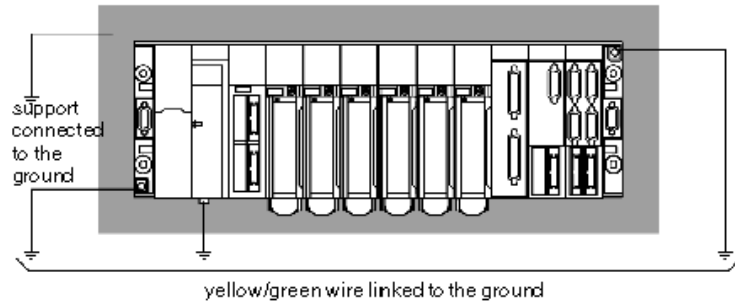

NOTE: The PLC's internal 0 V is linked to the ground connection, the ground connection itself being linked to ground.