

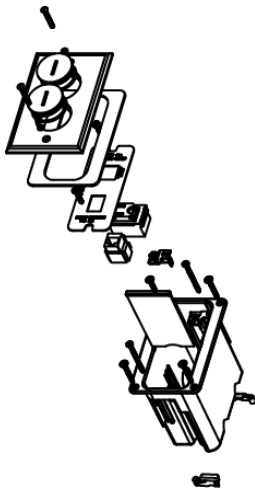

Wiremold
WMFB1SRKS1N Series Single-Gang Floor Box Assembly
Part No. WMFB1SRKS1N



Includes single-gang box, divider, one 15A, 125V receptacle, one opening for communication device, and nickel cover with two screw plugs. For hole cut dimensions, see installation instructions sheet. Box Dimensions: 2 1/8" W x 3 3/4" L x 3 7/8" D (54mm W x 95mm L x 98mm D) Device Plate: 3 1/8" W x 4 15/16" L (79mm W x 125mm L).

Features & Benefits

Includes single-gang box, divider, one 15A, 125V receptacle, one opening for communication device, and nickel cover with two screw plugs.

For hole cut dimensions, see installation instructions sheet.

Box Dimensions: 2 1/8" W x 3 3/4" L x 3 7/8" D (54mm W x 95mm L x 98mm D) Device Plate: 3 1/8" W x 4 15/16" L (79mm W x 125mm L).

Specifications

General Info

Product Line	Wiremold	UPC Number	786564054016
Country Of Origin	China	Construction	Not Assembled
Cover Style	Surface	Cover Material	Nickel
Application Sector	Commercial, Residential	Standard	cULus Listed Nonmetallic Outlet Boxes: File E143222 Guide QCMZ. Meets Article 314.27(C) of NEC.
Warranty Type	1-Year from Installation or 2-Years from Day of Sale	Type	Floor Box

Dimensions

Product Width US	2.125 in	Product Weight US	1.07 lb
Product Depth US	3.875 in	Knockout Size	1/2 in, 3/4 in

Listing Agencies / 3rd Party Agencies

cULus Listed Yes

Additional Information

RoHS Compliant Yes

Technical Information

Floor Type Wood Service Capacity Single

Minimum Floor Depth 5 in Box Capacity 1 Gang

Cable Entry Through Floor Box Type Recessed

Depth Behind Device Plates 3.87 in
