



**KNIPEX Cobra® QuickSet High-Tech Water Pump Pliers**  
DIN ISO 8976



87 21 250   
pliers grey afromentised, polished head, handles with non-slip plastic coating



87 22 250   
pliers grey afromentised, polished head, handles with slim multi-component covers



- Description
- Special
- Applications
- Fully open, push, grab!
- additional fast adjustment on the workpiece by sliding the pliers handle
- combines the proven, reliable locking of the hinge bolt with an additional push function which makes it easier to work in very confined and inaccessible areas
- the adjustment directly on the workpiece is possible by simply sliding the pliers handle
- reliable locking of the hinge bolt with the first workload. The gripping width of the pliers is then fixed and can only be adjusted by pressing the button.
- to re-activate the sliding function, the hinge bolt must be released by pressing the push button and the pliers must be completely opened again
- Chrome vanadium electric steel, forged, oil-hardened

The Cobra® QuickSet combines all proven properties of the KNIPEX Cobra® with an additional push on function which makes it easier to work in very confined and inaccessible areas. Adjustment directly on the workpiece is possible by simply sliding the pliers handle. The hinge bolt locks itself with the first workload. The gripping width of the pliers is then fixed and can only be adjusted by pressing the button. The hinge bolt must be released by pressing the button and the pliers must be completely opened once to activate the QuickSet function again.



Press the button – open pliers completely

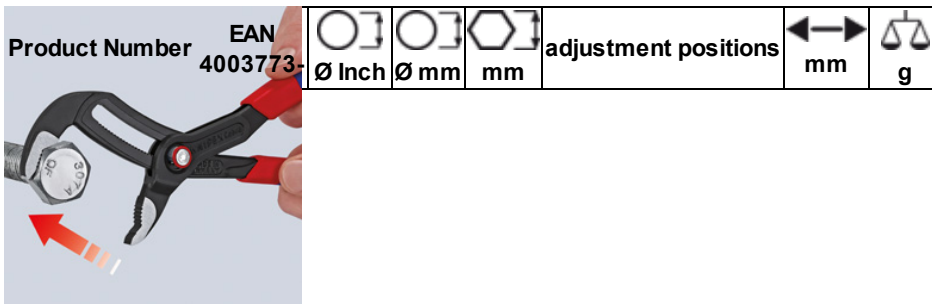



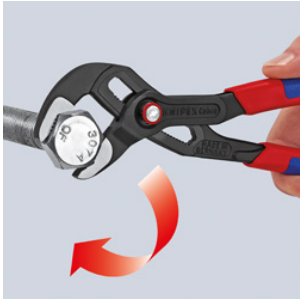

Position jaw – simply slide and close pliers



Hinge bolt locks itself with the first workload



Product Number	EAN 4003773-				adjustment positions		
		Ø Inch	Ø mm	mm		mm	g
87 21 250	072775	2	50	46	25	250	335
87 21 300	078524	2 3/4	70	60	25	300	530
87 22 250	077794	2	50	46	25	250	366

technical change and errors excepted