

### Main

|                                    |  |
|------------------------------------|--|
| Range of product                   | Lexium linear motion   |
| Product or component type          | Shaft journal  |
| Product specific application       | To connect an encoder and third-party application specific drive |
| Accessory / separate part category | Maintenance accessories  |

### Complementary

|                         |  |
|-------------------------|--|
| Product compatibility   | PAS 44 linear axis 110 x 110 mm<br>CAS 44 linear axis 110 x 110 mm |
| Range compatibility     | Lexium PAS<br>Lexium CAS   |
| Product weight          | 0.69 lb(US) (0.311 kg)   |
| Maximum radial force Fr | 1300 N   |
| Inertia                 | 0.54 kgcm <sup>2</sup>   |
| Torque value            | 1610.83 lbf.in (182 N.m)   |

### Ordering and shipping details

|                   |                                 |
|-------------------|---------------------------------|
| Category          | 18233-LINEAR MOTION ACCESSORIES |
| Discount Schedule | PC57                            |
| GTIN              | 3606485220062                   |
| Returnability     | No                              |
| Country of origin | DE                              |

### Packing Units

|                              |                    |
|------------------------------|--------------------|
| Unit Type of Package 1       | PCE                |
| Number of Units in Package 1 | 1                  |
| Package 1 Height             | 2.36 in (6.0 cm)   |
| Package 1 Width              | 4.72 in (12.0 cm)  |
| Package 1 Length             | 6.30 in (16.0 cm)  |
| Package 1 Weight             | 14.50 oz (411.0 g) |

### Contractual warranty

|          |           |
|----------|-----------|
| Warranty | 18 months |
|----------|-----------|

Dimensions

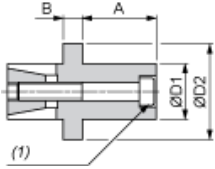

Dimensions in mm

| A  | B | ØD1 | ØD2 | ISO 4762 screw (1) |
|----|---|-----|-----|--------------------|
| 37 | 9 | 32  | 55  | M10                |

Dimensions in in.

| A    | B    | ØD1  | ØD2  | ISO 4762 screw (1) |
|------|------|------|------|--------------------|
| 1.46 | 0.35 | 1.26 | 2.16 | M10                |