

## Main

Range of product	Lexium linear motion
Product or component type	Adaptor
Accessory / separate part category	Maintenance accessories

## Complementary

Product compatibility	PAS 41 linear axis 40 x 40 mm PAS 42 linear axis 60 x 60 mm CAS 41 linear axis 40 x 40 mm CAS 42 linear axis 60 x 60 mm CAS 30 cantilever axis 70 x 28 mm CAS 31 cantilever axis 80 x 30 mm
Range compatibility	Lexium CAS Lexium PAS

## Ordering and shipping details

Category	18233-LINEAR MOTION ACCESSORIES
Discount Schedule	PC57
GTIN	3606485219981
Returnability	No
Country of origin	DE

## Packing Units

Unit Type of Package 1	PCE
Number of Units in Package 1	1
Package 1 Height	2.56 in (6.5 cm)
Package 1 Width	5.04 in (12.8 cm)
Package 1 Length	7.40 in (18.8 cm)
Package 1 Weight	3.25 oz (92 g)
Unit Type of Package 2	S04
Number of Units in Package 2	18
Package 2 Height	11.81 in (30 cm)
Package 2 Width	15.75 in (40 cm)
Package 2 Length	23.62 in (60 cm)
Package 2 Weight	5.34 lb(US) (2.42 kg)

## Offer Sustainability

California proposition 65	WARNING: This product can expose you to chemicals including: Lead and lead compounds, which is known to the State of California to cause cancer and birth defects or other reproductive harm. For more information go to <a href="http://www.P65Warnings.ca.gov">www.P65Warnings.ca.gov</a>
REACH Regulation	<a href="#">REACH Declaration</a>
REACH free of SVHC	Yes
EU RoHS Directive	Pro-active compliance (Product out of EU RoHS legal scope) <a href="#">EU RoHS Declaration</a>
Toxic heavy metal free	Yes
Mercury free	Yes
China RoHS Regulation	<a href="#">China RoHS Declaration</a>
RoHS exemption information	<a href="#">Yes</a>
PVC free	Yes

## Contractual warranty

Warranty	18 months
----------	-----------

Dimensions

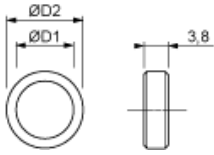

Dimensions in mm

ØD1	ØD2
5.5	8 h6

Dimensions in in.

ØD1	ØD2
0.22	0.31 h6