

## Main

|                           |   |
|---------------------------|---|
| Range compatibility       | Lexium 32<br>Lexium 62 ILM<br>Lexium 52<br>Lexium 15<br>Lexium 62 |
| Product or component type | Planetary gearbox   |
| Gear box type             | Straight teeth  |
| Device short name         | GBX   |
| Gearbox external diameter | 6.30 in (160 mm)  |
| Product compatibility     | SH3<br>MH3<br>ILM   |
| Reduction ratio           | 32:1  |

## Complementary

|                            |  |
|----------------------------|--|
| Maximum torsional backlash | 10 arc.min   |
| Torsional rigidity         | 41 N.m/arcmin  |
| Housing colour             | Black  |
| Housing material           | Black anodized aluminium   |
| Shaft material             | C 45   |
| Additional information     | Lubricated for life  |
| Service life in hours      | 30000 h 100 rpm 86 °F (30 °C)  |
| Efficiency                 | 94 %   |
| Mounting position          | Any position   |
| Maximum radial force Fr    | 4200 N 100 rpm, force applied at mid-distance from output shaft during 30000 hour at 30 °C<br>6000 N 100 rpm, force applied at mid-distance from output shaft during 10000 hour at 30 °C |
| Maximum axial force Fa     | 6000 N 100 rpm, during 30000 hour at 30°C<br>8000 N 100 rpm, during 10000 hour at 30°C   |
| Moment of inertia          | 0.00 lb.in <sup>2</sup> (6.36 g.cm <sup>2</sup> )  |
| Continuous output torque   | 7080.59 lbf.in (800 N.m) 100 rpm 86 °F (30 °C)   |
| Maximum output torque      | 11328.94 lbf.in (1280 N.m) 100 rpm 86 °F (30 °C)   |
| Net Weight                 | 48.50 lb(US) (22 kg)   |

## Environment

|                                   |                            |
|-----------------------------------|----------------------------|
| Noise level                       | 70 dB 1 m, no-load         |
| IP degree of protection           | Shaft output IP54          |
| Ambient temperature for operation | -13...194 °F (-25...90 °C) |

## Ordering and shipping details

|                       |                           |
|-----------------------|---------------------------|
| Category              | 18283 - NEUGART GEARBOXES |
| Discount Schedule     | PC53                      |
| GTIN                  | 03389118145146            |
| Nbr. of units in pkg. | 1                         |
| Package weight(Lbs)   | 1 lb(US) (0.45 kg)        |
| Returnability         | No                        |
| Country of origin     | DE                        |

## Packing Units

|                        |                  |
|------------------------|------------------|
| Unit Type of Package 1 | PCE              |
| Package 1 Height       | 10.24 in (26 cm) |
| Package 1 width        | 17.72 in (45 cm) |
| Package 1 Length       | 10.24 in (26 cm) |

## Contractual warranty

|          |           |
|----------|-----------|
| Warranty | 18 months |
|----------|-----------|

Dimensions

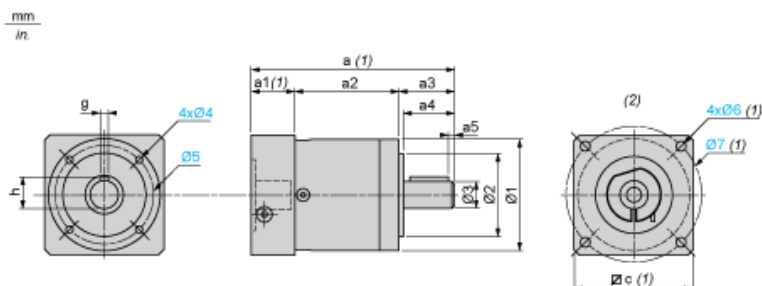

(1) Dimensions a, a1, c, Ø6 and Ø7 depend on the planetary gearbox/servo motor combination

(2) Servo motor assembly

Dimensions in mm

| a2    | a3 | a4 | a5 | h  | g  | Ø1  | Ø2     | Ø3    | Ø4 (oblong) | Ø5  |
|-------|----|----|----|----|----|-----|--------|-------|-------------|-----|
| 153.5 | 87 | 80 | 8  | 43 | 12 | 160 | 130 h7 | 40 h7 | M12 x 20    | 145 |

Dimensions in mm

| a   | a1   | c         | Ø6  | Ø7  |
|-----|------|-----------|-----|-----|
| 305 | 64.5 | 140 x 140 | M10 | 165 |

Dimensions in in.

| a2   | a3   | a4   | a5   | h    | g    | Ø1   | Ø2      | Ø3      | Ø4 oblong  | Ø5   |
|------|------|------|------|------|------|------|---------|---------|------------|------|
| 6.04 | 3.42 | 3.14 | 0.31 | 1.69 | 0.47 | 6.29 | 5.12 h7 | 1.57 h7 | M12 x 0.79 | 5.70 |

Dimensions in in.

| a     | a1   | c           | Ø6  | Ø7   |
|-------|------|-------------|-----|------|
| 12.00 | 2.53 | 0.21 x 0.21 | M10 | 6.49 |