

READ AND FOLLOW ALL SAFETY INSTRUCTIONS! SAVE THESE INSTRUCTIONS AND DELIVER TO OWNER AFTER INSTALLATION

- To reduce the risk of death, personal injury or property damage from fire, electric shock, falling parts, cuts/abrasions, and other hazards please read all warnings and instructions included with and on the fixture box and all fixture labels.
- Before installing, servicing, or performing routine maintenance upon this equipment, follow these general precautions.
- Installation and service of luminaires should be performed by a **qualified licensed electrician**.
- Maintenance of the luminaires should be performed by person(s) familiar with the luminaires' construction and operation and any hazards involved. Regular fixture maintenance programs are recommended.
- It will occasionally be necessary to clean the outside of the refractor/lens. Frequency of cleaning will depend on ambient dirt level and minimum light output which is acceptable to user. Refractor/lens should be washed in a solution of warm water and any mild, non-abrasive household detergent, rinsed with clean water and wiped dry. Should optical assembly become dirty on the inside, wipe refractor/lens and clean in above manner, replacing damaged gaskets as necessary.
- **DO NOT INSTALL DAMAGED PRODUCT!** This luminaire has been properly packed so that no parts should have been damaged during transit. Inspect to confirm. Any part damaged or broken during or after assembly should be replaced.
- Recycle: For information on how to recycle LED electronic products, please visit www.epa.gov.
- These instructions do not purport to cover all details or variations in equipment nor to provide every possible contingency to meet in connection with installation, operation, or maintenance. Should further information be desired or should particular problems arise which are not covered sufficiently for the purchaser's or owner's purposes, this matter should be referred to Acuity Brands Lighting, Inc.



WARNING RISK OF ELECTRIC SHOCK

- Disconnect or turn off power before installation or servicing.
- Verify that supply voltage is correct by comparing it with the luminaire label information.
- Make all electrical and grounded connections in accordance with the National Electrical Code (NEC) and any applicable local code requirements.
- All wiring connections should be capped with UL approved recognized wire connectors.



CAUTION RISK OF INJURY

- Wear gloves and safety glasses at all times when removing luminaire from carton, installing, servicing or performing maintenance.
- Avoid direct eye exposure to the light source while it is on.



WARNING RISK OF BURN

- Allow lamp/fixture to cool before handling. Do not touch enclosure or light source.
- Do not exceed maximum wattage marked on luminaire label.
- Follow all manufacturer's warnings, recommendations and restrictions for: driver type, burning position, mounting locations/methods, replacement and recycling.



CAUTION RISK OF FIRE

- Keep combustible and other materials that can burn, away from lamp/lens.
- Do not operate in close proximity to persons, combustible materials or substances affected by heat or drying.



CAUTION: RISK OF PRODUCT DAMAGE

- Never connect components under load.
- Do not mount or support these fixtures in a manner that can cut the outer jacket or damage wire insulation.
- Never connect an LED product to an unapproved dimmer pack. Contact ABL directly for any dimmers not specifically recommended for the product.
- Unless individual product specifications deem otherwise: Allow for some volume of airspace around fixture. Avoid covering LED fixtures with insulation, foam, or other material that will prevent convection or conduction cooling.
- Unless individual product specifications deem otherwise: Maximum ambient temperature is 90°C. Do not operate fixture at temperatures higher than this.
- Unless individual product specifications deem otherwise: Never mount in places where fixture will be exposed to rain, high humidity, extreme temperature changes or restricted ventilation.
- LED products are Polarity Sensitive. Ensure proper Polarity before installation.
- Electrostatic Discharge (ESD): ESD can damage LED fixtures. Personal grounding equipment must be worn during all installation or servicing of the unit.
- Do not touch individual electrical components as this can cause ESD, shorten lamp life, or alter performance.
- There are no user serviceable parts inside the unit. Do not rewire, reconfigure, or modify the unit or attempt any repairs yourself. Additionally, field replacement of the LED assembly or lamps is not allowed by UL standards at this time. In the unlikely event your unit may require service, stop using the unit immediately and contact an ABL representative.

All luminaires that contain electronic devices that generate frequencies above 9kHz from any component within the luminaire comply with one of the following Part 15 of the FCC Rules. Operation is subject to the following two conditions:

- (1) This device may not cause harmful interference
- (2) This device must accept any interference received, including interference that may cause undesired operation.

This device complies with Part 18 of the FCC Rules but may cause interference with cordless and cell phones, radios, televisions, and other electronic devices. To correct the problem move the device away from the luminaire or plug into a different outlet. This product may cause interference to radio equipment and should not be installed near maritime safety communications equipment or other critical navigation or communications equipment operating between 0.45-30MHz.

Failure to follow any of these instructions could void product warranties. For a complete listing of product Terms and Conditions, please visit www.acuitybrands.com.

OUR BRANDS

Indoor/Outdoor: Lithonia Lighting, Carandini, Holophane, RELOC

Indoor Lighting: Gotham, Mark Architectural Lighting, Peerless, Renaissance Lighting, Winona Lighting

Outdoor Lighting: American Electric Lighting, Antique Street Lamps, Hydrel, Tersen

Controls: DARK TO LIGHT, Lighting Control & Design, ROAM, Sensor Switch, Synergy

Acuity Brands Lighting, Inc. assumes no responsibility for claims arising out of improper or careless installation or handling of its products.

ABL LED General Warnings, Form No. 503.203

© 2010 Acuity Brands Lighting, Inc. All rights reserved. 12/01/10

**65BEMW
Module**

LED INSTRUCTIONS - 6" & 5" Matte White Baffle LED

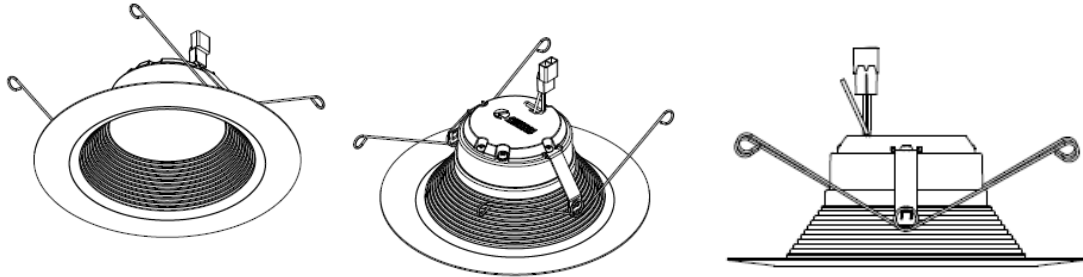

Step 1: Torsion Spring Brackets

Loosen (2) Torsion Bracket mounting screws on top of module (Figure 1) to adjust brackets and torsion springs to fit and align with either a 6" or 5" recess housing brackets-clips in ceiling.

Tighten Torsion Bracket mounting screws securely.

Note: The 65BEMW LED module only installs with the torsions springs, no other mounting clips are provided.

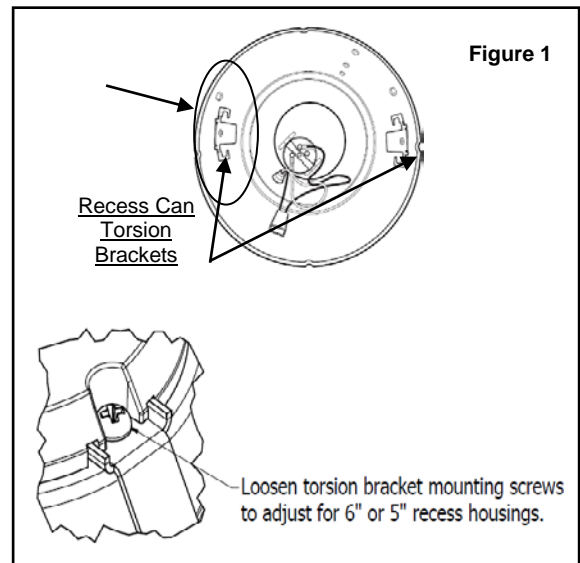

Step 2: Grounding Wire

NOTE – DO NOT LET THE MODULE HANG UNSUPPORTED BY THE ORANGE CONNECTOR (Figure 2)

- A. Recessed housing with grounding wire:
 1. Cut off the grounding wire eyelet from the LED module.
 2. Pair the LED module's bare copper grounding wire with the grounding wire from the recessed housing and secure with a wire nut.
- B. Recessed housing without grounding wire:
 1. Install the grounding wire eyelet into a 8-18 x 3/8" screw (Lithonia Lighting housings). Or,
 2. Install the eyelet through an 8-18 or equivalent self-tapping screw and secure into the housing wall.

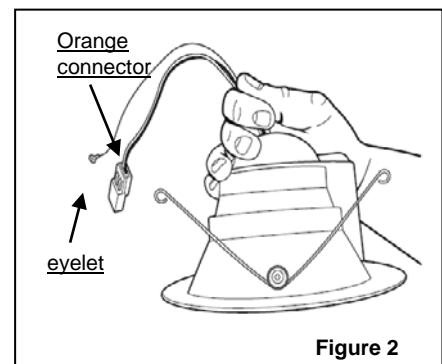

INSTALLATION INSTRUCTIONS
65BEMW LED (6", 5", and 4" Baffle LED Module)

Step 3: Determine Wiring Method (Select one wiring method)

- A. E26 Socket Adapter:
 1. Screw E26 socket adapter into the base socket inside the housing.
 2. Plug the orange connector of E26 socket adapter into the LED module's mating orange connector (see Figure 3). Or,
- B. LED Connector:
 1. Plug orange connector from the module into the mating orange connector in the recessed housing. -This type of connection complies with Title 24 (permanent LED installation).

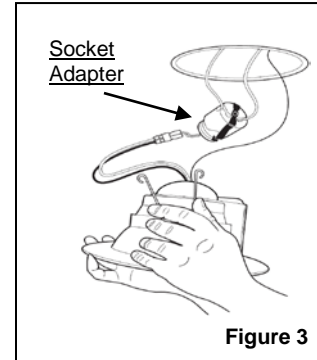

Note: No Hard wire Connection Kit is supplied with 65BEMW LED module.

Step 4: Installation of the module into the recessed housing

- A. Torsion springs: Squeeze each torsion spring together and seat them inside the housing torsion brackets. Release springs, and gently push module into housing until flush with ceiling. (Figure 4)

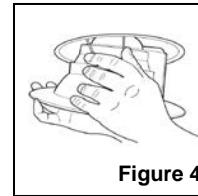

**4BEMW LED INSTRUCTIONS -
Baffle LED**

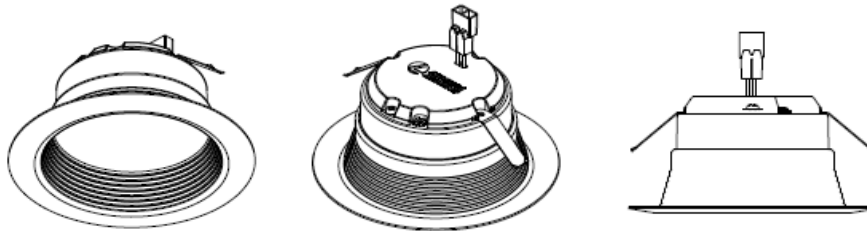

**4" Matte White
Module**

Step 1: Retention Spring Clips

Note: The 4BEMW LED module only installs with the retention springs, no other mounting clips are provided.

Step 2: Grounding Wire

NOTE – DO NOT LET THE MODULE HANG UNSUPPORTED BY THE ORANGE CONNECTOR (Figure 5)

- A. Recessed housing with grounding wire:
 1. Cut off the grounding wire eyelet from the LED module.
 2. Pair the LED module's bare copper grounding wire with the grounding wire from the recessed housing and secure with a wire nut.
- B. Recessed housing without grounding wire:
 1. Install the grounding wire eyelet into a 8-18 x 3/8" screw (Lithonia Lighting housings). Or,

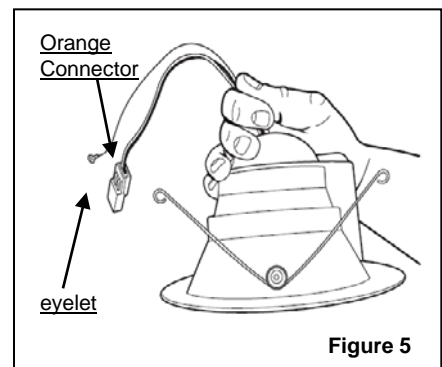

INSTALLATION INSTRUCTIONS
65BEMW LED (6", 5", and 4" Baffle LED Module)

2. Install the eyelet through an 8-18 or equivalent self-tapping screw and secure into the housing wall.

Step 3: Determine Wiring Method (Select one wiring method)

- A. E26 Socket Adapter:
1. Screw E26 socket adapter into the base socket inside the housing.
 2. Plug the orange connector of E26 socket adapter into the LED module's mating orange connector (see Figure 6). Or,
- B. LED Connector:
1. Plug orange connector from the module into the mating orange connector in the recessed housing. -This type of connection complies with Title 24 (permanent LED installation).

Note: No Hard wire Connection Kit is supplied with 65BEMW LED module.

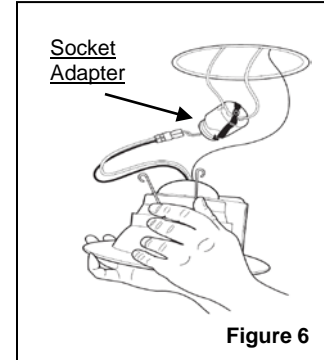

Step 4: Installation of the module into the recessed housing

- A. Spring retention clips: Center the LED module in the housing opening and gently push the module up into the housing evenly on all sides until flush with ceiling (Figure 7).

NOTE:

- Align the two retention clips with the recessed housing avoiding interference with anything protruding from the housing walls.
- For removal of a recessed LED module with retention clips, pull down and rotate back and forth until free. Use two standard flat blade screw drivers to pry the module apart from the recessed housing. This will aid in the removal process.

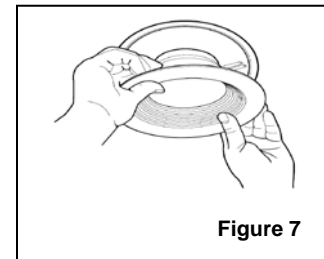

RECOMMENDED DIMMING SWITCHES: The LED Modules are compatible with a multiple of standard residential dimmers. A list of recommended dimmers can be found at www.lithonia.com, keyword search 65BEMW. Exclusion from the list does not mean a dimmer will not work in conjunction with your LED module. Consult with your dimmer manufacturer regarding compatibility with LED modules/lamps.

RECESSED CAN COMPATIBILITY: Lithonia's 6" LED modules are tested to fit in a minimum enclosure of 6.0" diameter by 5.75" height, with a maximum flange diameter of 7.5". For a list of compatible housings go to www.lithonialighting.com, keyword search 65BEMW.

LISTINGS: CSA certified to US and Canadian safety standards; Energy Star qualified; California Title 24 compliant; damp location listed; and WSEC ASTEM E283 for Air-Tight rated with IC housings. Minimum lamp compartment 6 inches (151 mm) diameters by 7 inches (179 mm) tall or minimum lamp compartment 198 IN3 (503cm3). Use only in open luminaires. Suitable for Type IC or Type Non-IC luminaires. The retrofit kit is accepted as a component of a luminaires where the suitability of the combination shall be determined by CSA or authorities having jurisdiction.

PATENTS PENDING