



Main

Range of Product	Altivar
Accessory / separate part category	Mounting and fixing accessory
Accessory / separate part type	Mounting kit
Accessory / separate part destination	Variable speed drive
Range Compatibility	Altivar 71 Altivar 71Q Altivar 32 Altivar 61 Altivar 212 Altivar 61Q Altivar Machine ATV320
IP Degree of Protection	IP54

Complementary

Kit composition	Screws and bolts for mounting Mounting hardware
Net Weight	0.33 lb(US) (0.15 kg)

Ordering and shipping details

Category	22135-ATV61-71 ACCESSORIES
Discount Schedule	CP4C
GTIN	3389118069312
Returnability	Yes
Country of origin	FR

Packing Units

Unit Type of Package 1	PCE
Number of Units in Package 1	1
Package 1 Height	2.95 in (7.500 cm)
Package 1 Width	6.50 in (16.500 cm)
Package 1 Length	9.06 in (23.000 cm)
Package 1 Weight	7.83 oz (222.000 g)
Unit Type of Package 2	S03
Number of Units in Package 2	7
Package 2 Height	11.81 in (30.000 cm)
Package 2 Width	11.81 in (30.000 cm)
Package 2 Length	15.75 in (40.000 cm)
Package 2 Weight	4.49 lb(US) (2.037 kg)
Unit Type of Package 3	P06
Number of Units in Package 3	56
Package 3 Height	29.53 in (75.000 cm)
Package 3 Width	23.62 in (60.000 cm)
Package 3 Length	31.50 in (80.000 cm)
Package 3 Weight	58.72 lb(US) (26.636 kg)

Offer Sustainability

California proposition 65	WARNING: This product can expose you to chemicals including: Lead and lead compounds, which is known to the State of California to cause cancer and birth defects or other reproductive harm. For more information go to www.P65Warnings.ca.gov
REACH Regulation	REACH Declaration
REACH free of SVHC	Yes
EU RoHS Directive	Pro-active compliance (Product out of EU RoHS legal scope) EU RoHS Declaration
Toxic heavy metal free	Yes
Mercury free	Yes
China RoHS Regulation	China RoHS Declaration
RoHS exemption information	Yes

Contractual warranty

Warranty	18 months
----------	-----------

Door Mounting Kit for Remote Graphic Display Terminal

Dimensions and Mounting

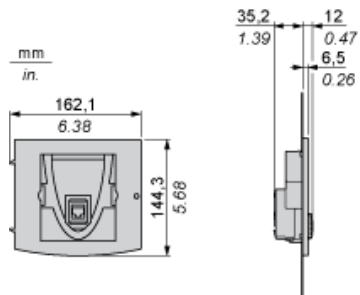

Cuts-outs and drill holes

