



HIGH BAY 360° SENSOR FIXTURE MOUNT BOX • 208/240 VAC • PASSIVE INFRARED (PIR)

SPECIFICATIONS

FEATURES

- 100% Digital PIR Detection, Excellent RF Immunity
- 360° Coverage Pattern
- Self-Contained Relays, No Power Packs Needed
- No Minimum Load Requirements
- Compatible w/ Electronic & Magnetic Ballasts, CFLs, LED, & Incandescents
- Interchangeable Hot & Load Wires, Impossible to Wire Backwards
- Push-Button Programmable
- Non-Volatile Settings Memory
- Adjustable Time Delays
- No Field Calibration or Sensitivity Adjustments Required
- Convenient Test Mode
- 100 hr Lamp Burn-in Timer
- Green LED Indicator

LAMPMAXIMIZER® TECHNOLOGY

- Protects Lamp Life while Maximizing Energy Savings
- Minimum On Timer (15 min default)
- Occ. Time Delay (10 min default)
- LampMaximizer+ Mode - Optimizes Lamp Life & Energy Savings (disabled by default)
- Switch Counter (in 1000's)
- Total Lamp On Time (in khrs)

PHYSICAL SPECS

SIZE 3.63" H x 3.63" W x 1.50" D
(9.22 cm x 9.22 cm x 3.81 cm)
WEIGHT 6 oz
MOUNTING 1/2" knockout
COLOR White

ELECTRICAL SPECS

MAXIMUM LOAD
5 Amps @ 208/240 VAC - Ballast
MINIMUM LOAD None
MOTOR LOAD 1/4 HP
FREQUENCY 50/60 Hz

ENVIRONMENTAL SPECS

OPERATING TEMP
14° to 160° F (-10° to 71° C)
RELATIVE HUMIDITY
20 to 90% non-condensing
SILICONE FREE
ROHS COMPLIANT

OVERVIEW

High bay lighting control is made simple with the **CMRB 6 208** Series occupancy sensor. This unique sensor is line powered and enables direct switching of 208/240 VAC lighting loads. Designed to mount at the end of a linear high bay fixture, this sensor's 360° coverage pattern overlaps that of most T-5, or T-8 fixtures used in warehouse applications. The **CMRB 6 208** switches both line voltage feeds going to a ballast, thus meeting the NEC requirements for simultaneously disconnecting all ungrounded conductors.

The **CMRB 6 208** sensor is best used in sensor per fixture applications. For multiple fixture control, use low voltage sensors, such as the **CMB 50** and/or **HMB 10** and power packs. For 120/277 VAC and 347 VAC applications, see the **CMRB 6** Series sensors. For 480 VAC applications, see the **CMRB 6 480** Series sensors.

SENSOR OPERATION

The sensor detects changes in the infrared energy given off by occupants as they move within the field-of-view. When occupancy is detected, dual self-contained relays switch the lighting on. The sensor is line powered, can switch two phases of 208 VAC line power going to a load, and requires no field calibration or sensitivity adjustments.

LAMPMAXIMIZER®

This sensor also contains patented LampMaximizer technology that allows users to aggressively target energy savings while still protecting lamp life. A minimum on timer, factory set at 15 minutes, helps preserve lamp life by eliminating all lamp cycles shorter than lamp manufacturers' recommendations.

A standard occupancy time delay is also present that ensures lights turn off (assuming minimum on timer has elapsed) if no occupancy is detected. This timer is factory set at 10 minutes to promote energy savings, but is adjustable between 30 seconds and 20 minutes. These adjustments can be done manually, through the unit's push-button, or automatically every two weeks through an advanced mode, called LampMaximizer+, that determines the optimum time delay in order to maximize both lamp life and energy savings. Additionally, this sensor maintains statistics on total lamp on time and number of cycles.

OPTIONS

PHOTOCELL (P)

- Photocell views down through sensor lens
- Auto set-point calibration
- Two selectable modes of operation
- On/Off mode: Photocell has full control during periods of occupancy
- Inhibit mode: Photocell can prevent lights from turning on if adequate daylight is available, but cannot turn lights off

LOW TEMP/HIGH HUMIDITY (LT)

- Sensor electronics are coated for corrosion resistance
- Operates down to -40° F/C
- Required for cooler/freezer applications



TITLE 24
ASSEMBLED in U.S.A.
5 YEAR WARRANTY

ORDERING INFO CMRB 6 208 [PHOTOCELL] [TEMP/HUMIDITY]

PHOTOCELL

Blank = None
P = Photocell

TEMP/HUMIDITY

Blank = Standard
LT = Low Temp

COVERAGE PATTERN

HIGH BAY 360° LENS

- Best choice for 15 to 45 ft (4.57 to 13.72 m) mounting heights
- 15 to 20 ft (4.57 to 6.10 m) radial coverage overlaps area lit by a typical high bay fixture
- Excellent detection of large motion (e.g. **walking**) up to a 35 ft (10.76 m) mounting height
- Excellent detection of extra large motion (e.g. **forklifts**) up to a 45 ft (13.72 m) mounting height

LOW VIEW

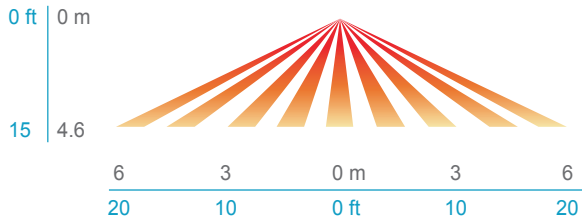

HIGH VIEW

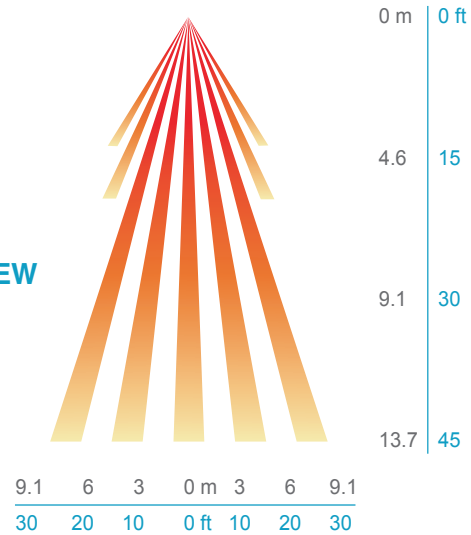

WIRING (DO NOT WIRE HOT)

STANDARD WIRING

- BLACK* - Phase A Line Input
- BLACK* - Phase A Load Output
- BLUE** - Phase B Line Input
- BLUE** - Phase B Load Output
- WHITE - Connect to either Line Input

INITIAL POWER UP

The sensor's relays are shipped in a latched closed position so the lights will come on upon initial power-up. If the lights do not immediately turn on (initial installation only) the latching relays opened during shipment and will close within 30 secs.

Note: If the sensor loses power, the relays will latch closed.

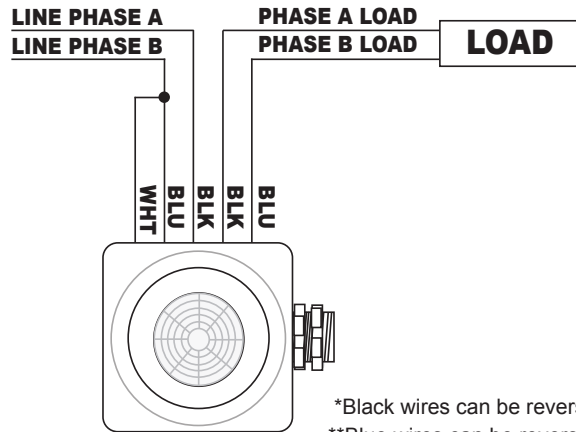

*Black wires can be reversed
**Blue wires can be reversed

INSTALLATION

- Sensor mounts through a 1/2" knockout hole to a fixture or junction box.
- A label kit is included to mask off half of the sensor's coverage pattern for end of aisle, or trim the side viewing to create a rectangular pattern for center of aisle.
- If the sensor's field-of-view is partially blocked by the fixture housing, the FB3 Fixture Bracket (not included) can be used to lower the sensor down to a level where its view is not impaired.

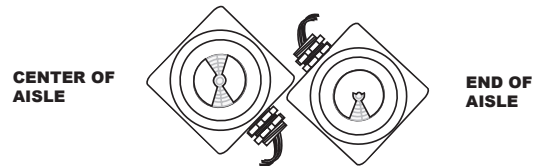
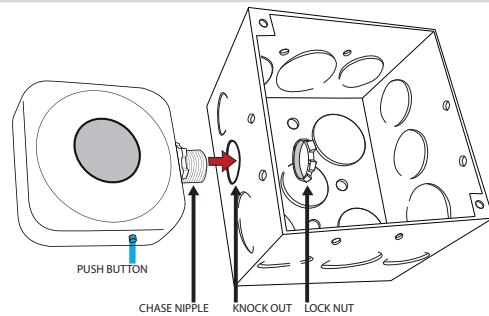
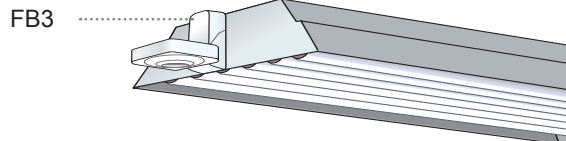

PROGRAMMING

Refer to instruction IC7.001 card for default settings and directions on programming the sensor via the push-button.

sensorswitch

An AcuityBrands Company

WARRANTY: Sensor Switch, Inc. warrants these products to be free of defects in manufacture and workmanship for a period of 60 months. Sensor Switch, Inc., upon prompt notice of such defect, will, at its option, provide a Returned Material Authorization number and repair or replace returned product.

LIMITATIONS AND EXCLUSIONS: This Warranty is in full lieu of all other representation and expressed and implied warranties (including the implied warranties of merchantability and fitness for use) and under no circumstances shall Sensor Switch, Inc. be liable for any incidental or consequential property damages or losses.

TS-CMRB-008A