

# COPPER PENN-CRIMPS® TELECOM LUGS • BBLU-2TC

## 2 hole long barrel lugs for #8 stranded thru 2000 MCM

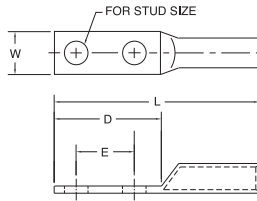

### COLOR-CODED COPPER COMPRESSION CONNECTORS



Connector Family	POWER UL 486A/ CSA22.2 No. 65 Wire Range	UL 467 GROUNDING			CSA C22.2 NO. 41 GROUNDING		
		UL Grounding Max. Wire	Grounding & Bonding	Direct Burial	CSA Grounding Max. Wire	Grounding & Bonding	Direct Burial
BBLU, BBLU, BBLZ, BCU, BBCU	8 Str.- 2000 MCM	500 MCM	YES	YES	250 MCM	YES	YES

POWER: UL 486A, CSA C22.2 NO. 65  
 GROUNDING & BONDING & DIRECT BURIAL : UL 467, CSA C22.2 NO. 41

- Longer length barrel permits extra crimps for additional assurance on heavy duty loads.
- Seamless, one piece, pure copper construction with tin plating assures maximum conductivity.
- Generous entrance chamfer provides easy cable insertion.
- End of cable is protected from environmental hazards by completely closed transition.
- Catalogue number and conductor sizes marked on every piece insures positive identification.
- 45° and 90° variations are UL listed and CSA certified.

- Contact factory for price and availability.
- Can be installed with existing crimping tools.
- Die colour coding conforms to industry requirements to insure proper connector/die selection and to provide for faster installation.
- Accepts the same wide range of additional wire sizes and types as our standard BBLU series.
- New feature - UL/CSA approved with Versa-Crimp® tooling and wire ranges. Versa-Crimp® is a registered trademark of Hubbell Incorporated.
- BBLU lugs are suitable for use at voltages up to 35KV.

NOW LISTED FOR GROUNDING, BONDING & DIRECT BURIAL APPLICATIONS

NEW FEATURE!

Part #	Copper Cond. Range+	Wire Dia. (in)	Stud Size	Approximate Dimensions (in inches)				Die Color Code	Crimping Tool Reference					
				E	W	D	L		PENN-UNION			Alt. Tooling		
									Dieless Mechanical	Pressure Setting		PUC Dies	Burndy Index No.	T&B Die
				TDY-1	TDY-U									
BBLU 8D 2TC14	#8 Str.	.146	1/4	.63	.41	1.22	2.44	Red	PUC TDM-250 or TDM-500	-	-	T-6	B-6	21
BBLU 8D 2TC14E2			1/4	.75	.41	1.36	2.58							
BBLU 8D 2TC38E3			3/8	.81	.56	1.83	3.05							
BBLU 8D 2TC38			3/8	1	.56	1.83	3.05							
BBLU 6D 2TC14	#6 Str.	.184	1/4	.63	.41	1.22	2.60	Blue	PUC TDM-250 or TDM-500	-	-	T-7*/374*	B-7	24
BBLU 6D 2TC14E2			1/4	.75	.41	1.36	2.74							
BBLU 6D 2TC38E2			3/8	.75	.61	1.58	2.96							
BBLU 6D 2TC38E3			3/8	.81	.61	1.83	3.21							
BBLU 6D 2TC38			3/8	1	.61	1.83	3.21							
BBLU 6DN			1/2	1.75	.81	3.00	4.38							
BBLU 5D 2TC14	#5 Str.	.206	1/4	.63	.44	1.22	2.60	Blue	PUC NONE	-	-	T-7*/374*	B-7	24
BBLU 5D 2TC14E2			1/4	.75	.44	1.36	2.74							
BBLU 5D 2TC38E2			3/8	.75	.61	1.58	2.96							
BBLU 5D 2TC38E3			3/8	.81	.61	1.83	3.21							
BBLU 5D 2TC38			3/8	1	.61	1.83	3.21							
BBLU 4D 2TC14	#4 Str.	.232	1/4	.63	.50	1.22	2.60	Gray	PUC TDM-250 or TDM-500	2	-	T-8*/346*	B-8	29
BBLU 4D 2TC14E2			1/4	.75	.50	1.36	2.74							
BBLU 4D 2TC38E2			3/8	.75	.61	1.58	2.96							
BBLU 4D 2TC38E3			3/8	.81	.61	1.83	3.21							
BBLU 4D 2TC38			3/8	1	.61	1.83	3.21							
BBLU 4D1	1/2	1.75	.94	3.00	4.38									
BBLU 3D 2TC14	** #3 Str.	.260	1/4	.63	.65	1.22	2.60	White	PUC NONE	2	-	T-9*	B-9	-
BBLU 3D 2TC14E2			1/4	.75	.65	1.36	2.74							
BBLU 3D 2TC38E2			3/8	.75	.65	1.58	2.96							
BBLU 3D 2TC38E3			3/8	.81	.65	1.83	3.21							
BBLU 3D 2TC38			3/8	1	.65	1.83	3.21							
BBLU 2D 2TC14	#2 Str.	.292	1/4	.63	.59	1.22	2.75	Brown	PUC TDM-250 or TDM-500	2	-	T-10	B-10	33
BBLU 2D 2TC14E2			1/4	.75	.59	1.36	2.89							
BBLU 2D 2TC38E2			3/8	.75	.59	1.58	3.11							
BBLU 2D 2TC38E3			3/8	.81	.59	1.83	3.36							
BBLU 2D 2TC38			3/8	1	.59	1.83	3.36							
BBLU 2D 2NTC38			3/8	1.75	.59	2.58	4.11							
BBLU 2D6	1/2	1.75	.81	3.00	4.53									
BBLU 1D 2TC14	#1 Str.	.332	1/4	.63	.67	1.22	2.94	Green	PUC TDM-250 or TDM-500	2	-	T-11/375	B-11	37
BBLU 1D 2TC14E2			1/4	.75	.67	1.36	3.08							
BBLU 1D 2TC38E2			3/8	.75	.67	1.58	3.30							
BBLU 1D 2TC38E3			3/8	.81	.67	1.83	3.55							
BBLU 1D 2TC38			3/8	1	.67	1.83	3.55							
BBLU 1D2			1/2	1.75	.78	3.00	4.72							

Installation tools see page F-24

† Note: On double hole lugs: Nema spacing #10 & 1/4" studs - 3/8" centers, 3/8" studs - 1" centers, 1/2" studs - 1 3/4" centers.  
 CSA approved with T&B, Burndy, Versa-Crimp, Huskie Tooling and Penn-Union Tools. See CSA File # LR23769-20, figure A5, appendix I.