

# Liquidtight Fittings

## For Threaded RMC and IMC

### Type 4Q-FM - Combination Couplings

#### Use:

Secures, grounds and seals liquidtight flexible metal conduit to threaded rigid conduit and IMC.

#### Features:

- Female hub, NPT for connection to threaded conduit
- Liquidtight/Raintight/Oiltight/Concretetight
- UL Listed NEMA Type 4 when installed into a NPT threaded entry or UL Listed conduit hub (sizes 1¼" and larger require thread sealant).
- Suitable for grounding through 1¼" Trade Size per NEC Section 250.118(7)
- For Trade Sizes 1½" and larger, an internal or external equipment bonding conductor is required. See 4Q-L Series with external ground lug in Catalog Section GB.
- Suitable for use in the following Hazardous Locations:
  - Class I, Div. 2 per NEC 501.4(B)
  - Class I, Zone 2 per NEC 505.15(C)(2)
  - Class II, Div. 1 per NEC 502.4(A)(1)(e)
  - Class II, Div. 2 per NEC 502.4(B)(2)
  - Class III, Div. 1 per NEC 503.3(A)(2)
  - Class III, Div. 2 per NEC 503.3(B)
- Intrinsically Safe per NEC 504.20
- Bonding Wedge Locknuts are recommended in Hazardous Locations. See 101 Series on Page DB8.
- Suitable for wet locations
- Long ferrule prevents pullout and tight bend conduit "pop-out"
- Reusable ferrule
- Inspection windows in ferrule to ensure full engagement
- See Page GC4 for our patented Ferrule Wrench which makes ferrule installation easy.

#### Material/Finish:

Malleable Iron/Zinc Plated  
Steel Ferrule/Zinc Plated

#### Optional Finish:

Hot Dip or Mechanical Galvanize, add suffix "G" to catalog number. Contact your local representative for pricing and availability.

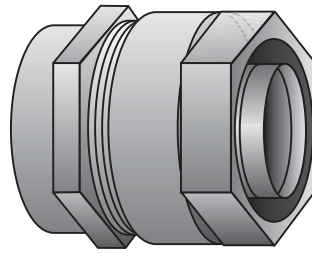

Type 4Q-38FM — Type 4Q-200FM

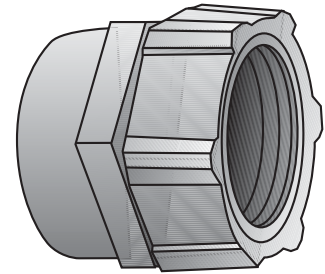

Type 4Q-250FM — Type 4Q-500FM

Trade Size (inches)	Catalog Number	Dimensions in Inches		
		A	B	C
⅜ (½ KO)	4Q-38FM	1 <sup>11</sup> / <sub>16</sub>	1 <sup>3</sup> / <sub>16</sub>	1 <sup>1</sup> / <sub>8</sub>
½	4Q-50FM	1 <sup>1</sup> / <sub>16</sub>	1 <sup>1</sup> / <sub>16</sub>	1 <sup>1</sup> / <sub>4</sub>
¾	4Q-75FM	1 <sup>5</sup> / <sub>8</sub>	1 <sup>1</sup> / <sub>16</sub>	1 <sup>1</sup> / <sub>2</sub>
1	4Q-100FM	1 <sup>13</sup> / <sub>16</sub>	1 <sup>13</sup> / <sub>16</sub>	1 <sup>3</sup> / <sub>4</sub>
1¼	4Q-125FM	2	2 <sup>3</sup> / <sub>8</sub>	2 <sup>1</sup> / <sub>2</sub>
1½	4Q-150FM	2 <sup>1</sup> / <sub>8</sub>	2 <sup>5</sup> / <sub>8</sub>	2 <sup>3</sup> / <sub>4</sub>
2	4Q-200FM	2 <sup>1</sup> / <sub>4</sub>	3 <sup>1</sup> / <sub>4</sub>	3 <sup>1</sup> / <sub>4</sub>
2½	4Q-250FM	3 <sup>1</sup> / <sub>4</sub>	3 <sup>7</sup> / <sub>8</sub>	4 <sup>1</sup> / <sub>8</sub>
3	4Q-300FM	3 <sup>3</sup> / <sub>8</sub>	4 <sup>1</sup> / <sub>8</sub>	4 <sup>1</sup> / <sub>8</sub>
3½	4Q-350FM	3 <sup>5</sup> / <sub>8</sub>	5 <sup>3</sup> / <sub>8</sub>	4 <sup>1</sup> / <sub>8</sub>
4	4Q-400FM	3 <sup>3</sup> / <sub>4</sub>	5 <sup>1</sup> / <sub>4</sub>	6 <sup>1</sup> / <sub>8</sub>
5	4Q-500FM*	3 <sup>5</sup> / <sub>8</sub>	6 <sup>1</sup> / <sub>8</sub>	7 <sup>1</sup> / <sub>8</sub>

\*UL Listing not applicable

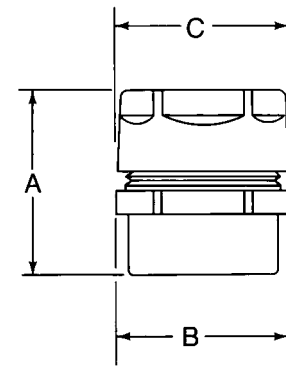

#### Third Party Certification:



UL Listed: 11853



CSA Certified: 009795

#### Applicable Third Party Standards:

UL Standard: 514B

CSA Standard: C22.2 No. 18

NEMA: FB-1

Federal Spec: W-F-406E