

# 10

## ONE Series

# FEEL THE SILENCE

THE WORLD'S FIRST MODULAR DRYER - OUR FAMOUS QUIET MODEL "ONE" WITH NEW DESIGN AND TECHNOLOGY- FEEL THE SAME SILENCE

## FEATURES

- Quietest hand dryer in the industry at 65 db. Now, 12 seconds drying time
- Automatic infrared actuated sensor, for power conservation and maximum hygiene
- Robust, tamperproof design and construction for greater product durability and longevity in application
- **Exclusive : Adjustable output airflow temperature**
- High improved velocity (8600 LFM) airflow for faster hand drying
- Universal voltage
- Modular design for easy repair
- Designed for easy installation
- **Dynamic changeable LED colored lighting (by end user)**
- Vandal proof
- Tamperproof screws

## APPLICATIONS

- Washrooms | Clean up Areas
- Commercial Facilities, Factories, Restaurants, Hospitals, Office buildings
- Residential

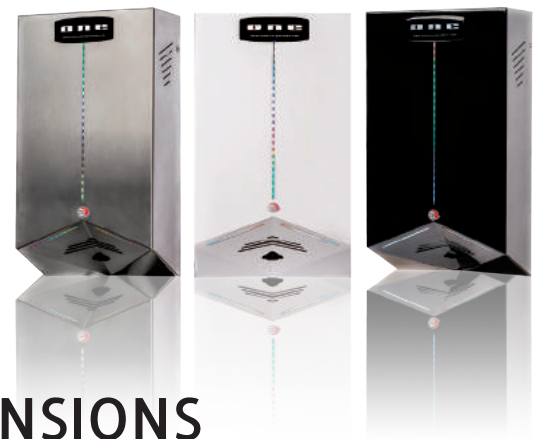
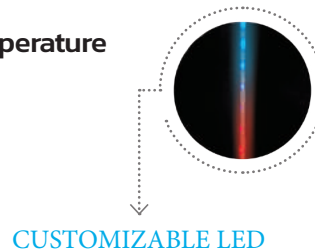

## DIMENSIONS

### BACK VIEW

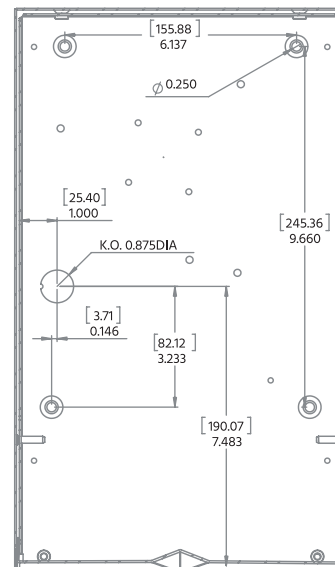

### SIDE VIEW

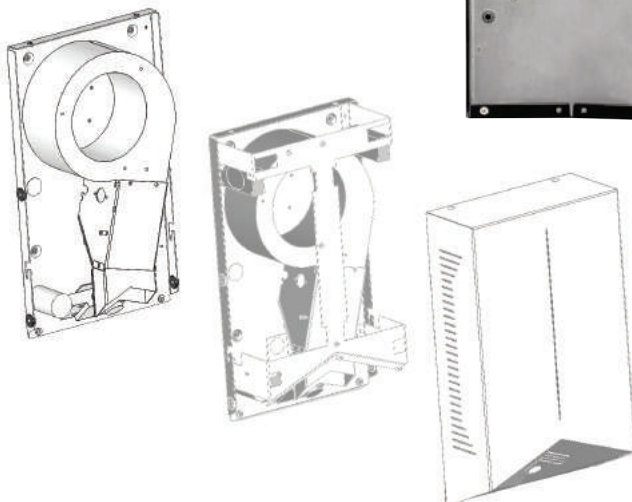
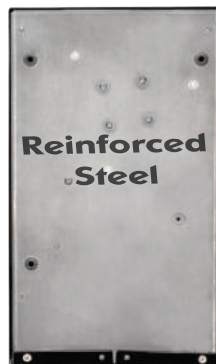
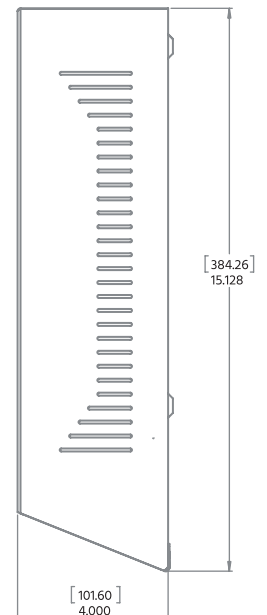

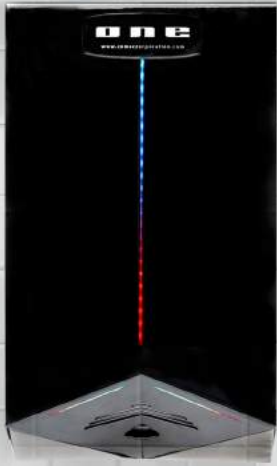

White



Black

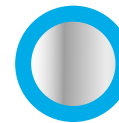

Stainless Steel



Chrome

## SPECIFICATIONS

**Voltage** Universal 115-230\*VAC (\*50/60Hz)  
**Wattage** 1450 W at 5.7A (230VAC)  
**Motor** 1800 RPM brushless external rotor  
**Colour** White, Black and Stainless steel  
**Finish** Chrome, scratch-resistant porcelain, brushed stainless steel  
**Heating Element** 1380w resistance coil  
**Construction Material** Reinforced Steel

**Controls & Wiring** Automatic resetting thermostat with cutout when airflow is restricted-Infrared sensor cutout two seconds after hand removal, and 60 seconds after initiating drying  
**Installation** Removable predrilled baseplate for easy mounting  
**Warranty** 10 years parts.  
 CSA certified for use in Canada and the U.S.  
 CE approved for use where applicable.  
**Patent Pending**

## ORDERING GUIDE

Model No.	Colour	Watts	Volts Hz	Air Velocity LFM	Air Volume CFM	Noise dB	Dimensions (W x H x D) (mm/in.)	Weight (kg/lbs.)
C-100000000	White	1450	115-230,50-60	8600	150	65	223 x 384 x 105 (8.77 x 15.11 x 4.13)	5.7/12.5
C-100000002	Black	1450	115-230, 50-60	8600	150	65	223 x 384 x 105 (8.77 x 15.11 x 4.13)	5.7/12.5
C-100220004	Brushed stainless steel	1450	115-230, 50-60	8600	150	65	223 x 384 x 105 (8.77 x 15.11 x 4.13)	5.7/12.5
C-100220006	Chrome	1450	115-230, 50-60	8600	150	65	223 x 384 x 105 (8.77 x 15.11 x 4.13)	5.7/12.5



COMMERCIAL HAND DRYERS TO ORDER PLEASE CALL 1-855-550-0303

