

| | |
|-----------|--------|
| PROJECT: | DATE: |
| CAT. NO.: | TYPE: |
| NOTES | VOLTS: |

GENERAL

Fluorescent lighting strip suitable for T8 lamp application. Designed to accommodate continuous row mounting. Wire guard option available.

CONSTRUCTION

Rigid die-formed body constructed from code gauge steel. One-piece endplate / socket bracket is rotated prior to shipping to prevent socket breakage. Joiner for continuous row mounting is incorporated in endplate / socket bracket.

FINISH

Standard finish is baked white enamel.

ELECTRICAL

Instant start electronic ballast, 120V-50/60Hz. Other ballasts and voltages available upon request.

CERTIFICATIONS

CSA and/or UL approved.

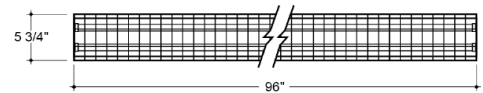
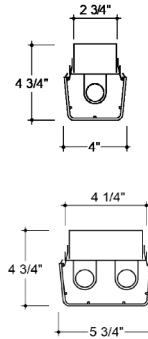

Ordering Information

| LS | MODULE LENGTH | LAMPS | WATTS | OPTIONS | VOLTAGE | BALLAST / DRIVER |
|--------|--|-------------------------|--|---------------|---|---------------------------------|
| SERIES | | | | | | |
| | 2 = 24" 3 = 36" 4 = 48" 8 = 96" | 1 = 1 2 = 2 4 = 4 | 17 = 17 (T8) 25 = 25 (T8) 32 = 32 (T8) | G = Wireguard | 120 = 120 Volts 277 = 277 Volts 347 = 347 Volts | IS = IS PRS = PRS RS = RS |